

Vort PIV Wall

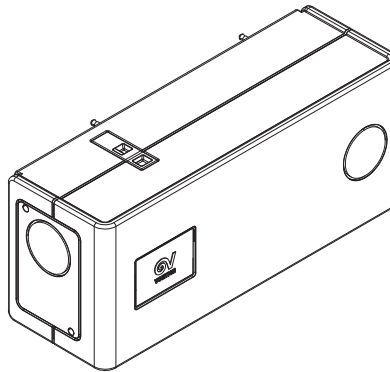

Vort PIV W RH

Vort PIV W RH RF



Vort PIV W LH

Vort PIV W LH RF

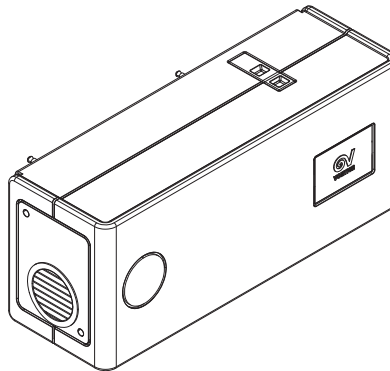

Read the instructions contained in this booklet carefully before using the appliance.

Vortice cannot assume any responsibility for damage to property or personal injury resulting from failure to abide by the instructions given in this booklet.

Following these instructions will ensure a long service life and overall electrical and mechanical reliability.

Keep this instruction booklet in a safe place.

Prima di usare il prodotto leggere attentamente le istruzioni contenute nel presente libretto.

Vortice non potrà essere ritenuta responsabile per eventuali danni a persone o cose causati dal mancato rispetto delle indicazioni di seguito elencate, la cui osservanza assicurerà invece la durata e l'affidabilità, elettrica e meccanica, dell'apparecchio.

Conservare sempre questo libretto istruzioni.

Table of contents

EN

General information	3
Product description	4
Compliance	4
Safety/Warnings	5
Configurations	6
General warnings for the Installer	8
Installation	9
Commissioning	17
Operation	17
Use	19
Maintenance and cleaning	29
Available accessories	30
Wiring diagrams	30
Troubleshooting	32
Disposal	33

Indice

IT

Informazioni generali	34
Descrizione prodotto	35
Conformità d'uso	35
Sicurezza/Avvertenze	36
Configurazioni	37
Avvertenze generali per l'installatore	39
Installazione	40
Prima attivazione	48
Funzionamento	48
Utilizzo	50
Manutenzione e pulizia	60
Accessori disponibili	61
Schemi di collegamento	61
Risoluzione dei problemi	63
Smaltimento	64

ENGLISH

General Informations

Description of the symbols

Obligation



Generic obligation



Reading the instructions is mandatory



Turn off the power is mandatory



Contact a professionally qualified electrician

Prohibition



Generic prohibition

Danger



Generic danger

Purpose of the manual

This manual contains information on the use and maintenance of the appliance and provides useful information for the correct use of the appliance.



Before installing and using the appliance, read the warnings in this manual carefully

Vortice cannot assume any responsibility for damage to property or personal injury resulting from failure to abide by the instructions given in this booklet.

Following these instructions will ensure a long service life and overall electrical and mechanical reliability. Keep this instruction booklet in a safe place. Do not make modifications to this manual.

Product description

Vort PIV W (hereinafter "the appliance") is a PIV (Positive Input Ventilation) ventilation unit with continuous operation, designed to be installed on the wall in apartments, especially where there is no attic. The appliance introduces into the apartment clean (eventually heated) air, taken from the outside, after particle filtering. Positive inlet ventilation (PIV) by introducing clean air into the apartment, contributes to the reduction of humidity, counteracting the formation of mould, and contributes to the reduction of Radon, if present.

The models of the Vort PIV W family are:

- **Vort PIV W RH** with air outlet to the right;
- **Vort PIV W LH** with air outlet to the left;
- **Vort PIV W RH RF** with air outlet to the right and RF remote switch;
- **Vort PIV W LH RF** with air outlet to the left and RF remote switch.

The main components of the device are (fig. 1):

1. Fan motor unit
 2. Heater
 3. Filtering system: (G3(ISOCoarse 30%) on board, or G4(ISOCoarse 60%), or F7(ePM2,5 70%) optional);
 4. Control panel equipped with an LCD display, hidden by a protective cover;
 5. RF receiver (RF models only);
- An RF remote switch can be connected (RF models only).

Wired switches (not supplied) can be used to select normal or boost speed, and switch the heater on / off.

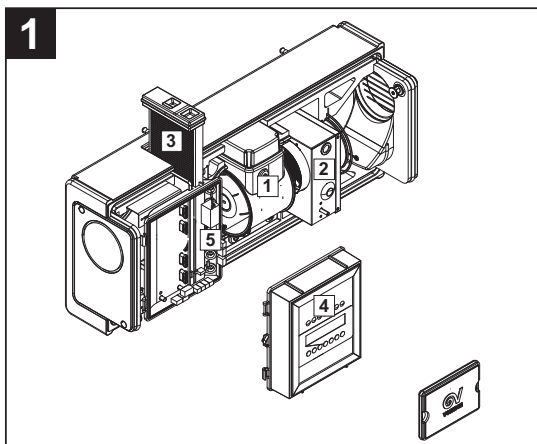

For details regarding operation, see the Operation and Use paragraphs.

Contents of the box (fig.1b):

1. Appliance
2. Air outlet vent (x2)
3. Hooks
4. Tool for removing the front cover
5. Spacers/screws (side panels)
6. Cap type A
7. Caps type B
8. Spacer
9. Washer, dowel and screw

10. Instructions booklet

11. Drilling template

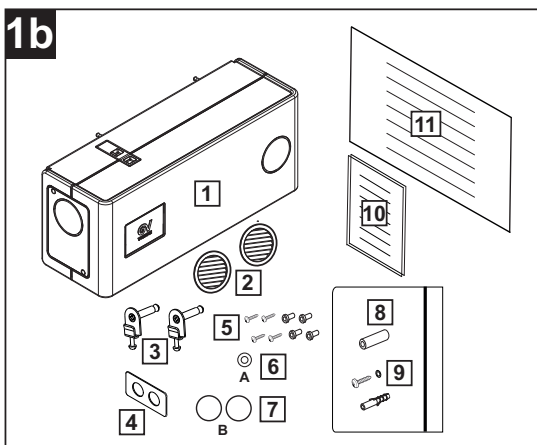

Compliance

- This appliance can be used by children aged from 8 years and above and persons with reduced physical, sensory or mental capabilities or lack of experience and knowledge if they have been given supervision or instruction concerning use of the appliance in a safe way and understand the hazards involved.

ENGLISH

Children shall not play with the appliance. Cleaning and user maintenance shall not be made by children without supervision.

- These appliances are designed for use in residential and commercial properties.
- The appliance must be installed by a professionally qualified electrician.
- The electrical system to which the product is connected must be in compliance with applicable regulations. 
- An omnipolar switch with a contact opening distance of 3 mm or higher should be provided for installation, enabling complete disconnection under overvoltage category III conditions.
- Products equipped with single-phase wiring (M) engines ALWAYS require connection to 220-240V (or only 230V where required) single-phase lines. Any kind of modification shall be considered as product tampering and shall nullify the relative Warranty.

Safety/Warnings



- After removing the appliance from its packaging, ensure that it is complete and undamaged. If in doubt contact an authorised Vortice service centre. Do not leave packaging within the reach of children or differently able persons.
- Store the appliance out of the reach of children and disabled persons if you decide to disconnect it from the power supply and use it no more.
- If the appliance malfunctions and/or develops a fault, contact Vortice immediately. Ensure that only genuine original Vortice spares are used for any repairs.
- The electrical power supply/socket to which the appliance is to be connected must be able to provide the maximum electrical power required by the appliance. If it cannot do so, arrange for a qualified electrician to make the necessary modifications.
- Electrical connections must comply with "The Building Regulations" and the most current version of IET regulation BS7671 in the UK (or equivalent regulations in other countries).
- The electrical specifications correspond to the ones on the rating label.



- Do not use this appliance for functions other than those described in this booklet.
- Do not make modifications of any kind to this appliance.
- Do not install this appliance in areas where the following may be present or occur:
 - excessive oil or a grease laden atmosphere;
 - ambient temperatures higher than 40°C or less than -10°C;
 - possible obstructions which would hinder access or removal of the fan;
 - relative humidity above 90%;
 - sudden ductwork bends or transformations close to the appliance;
 - maximum height available from the floor <1,8m.



- Certain fundamental rules must be observed when using any electrical appliance:
 - never touch appliances with wet or damp hands;
 - never touch appliances while barefoot;
 - do not allow the unit to be operated by unsupervised children or disabled persons.
- Should the appliance be dropped or suffer a heavy blow, have it checked immediately by Vortice.
- If the power cord becomes damaged, it must be replaced by the manufacturer or its technical assistance service, or in any case by a person with similar qualifications, in order to prevent any risk.

ENGLISH

Configurations

Two versions of the appliance are available, depending on the direction of the air flow (fig.2,3)

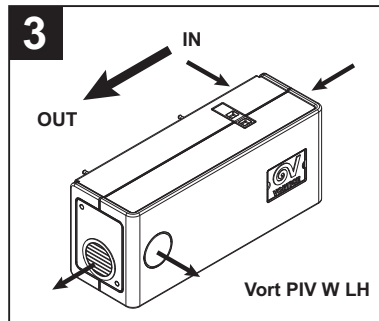
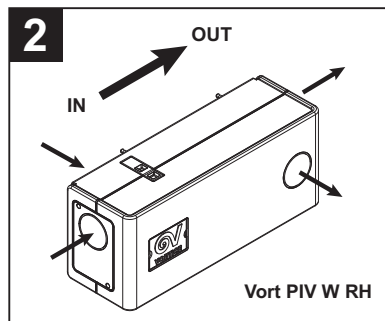

In each version it is possible to create the air inlet and outlet using the different vents on the device in various ways: 3 for the air inlet, 2 for the outlet, also simultaneously active (see fig. 4,5: simplified diagrams, related to the RH version: air outlet to the right).

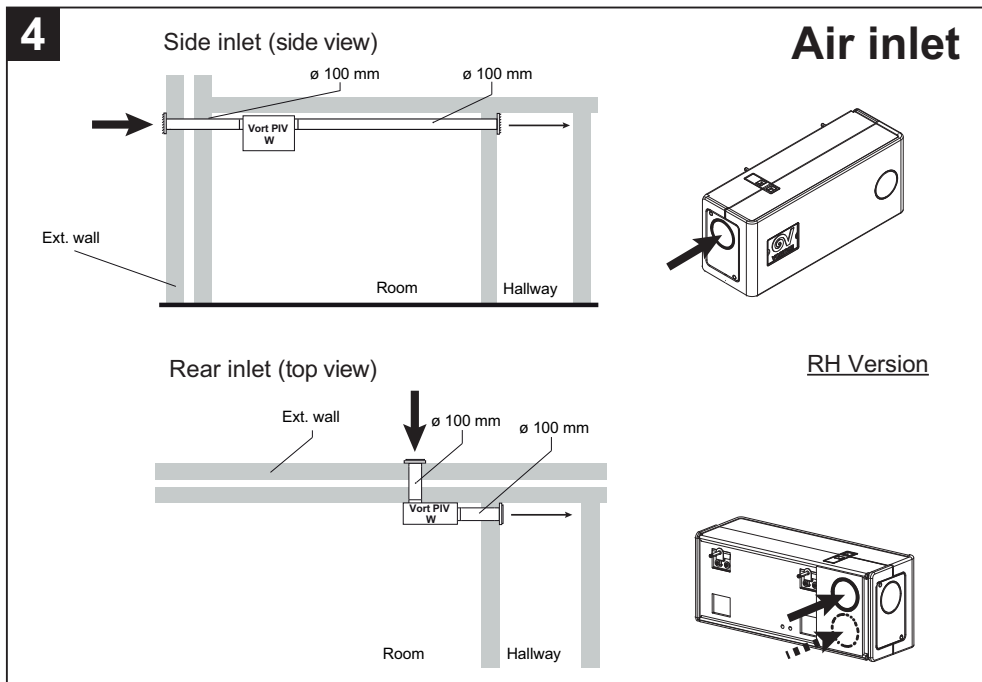

5

Side outlet (side view)

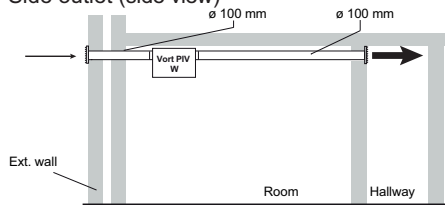

Frontal outlet (top view)

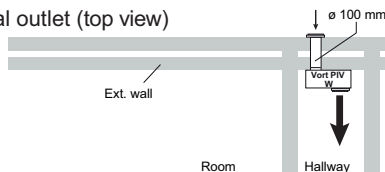

Side + Frontal outlet (top view)

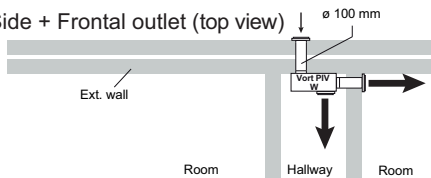

Air outlet

RH Version

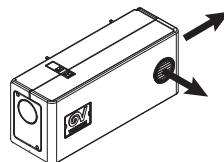
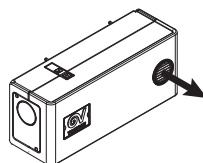
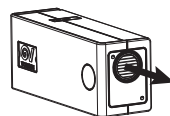

NOTE: in order to facilitate installation operations, depending on the layout of the pipes, the side vents can be rotated to make the inlet/outlet in two different positions (fig. 6: inlet example): this can make it easier to adapt the position of the spigot to the position of the pipe and possibly avoid a bend in the pipe.

6

Side view RH Version

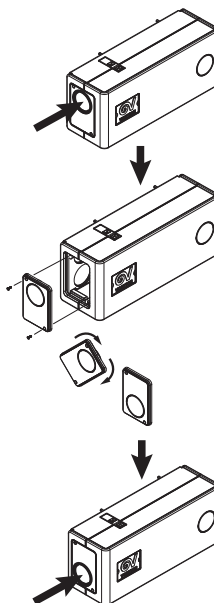
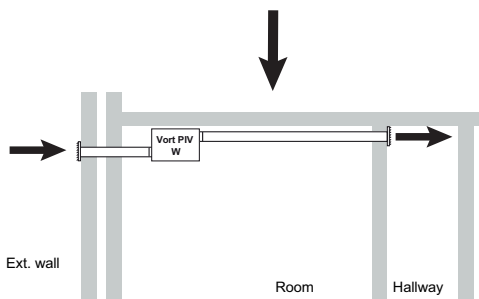
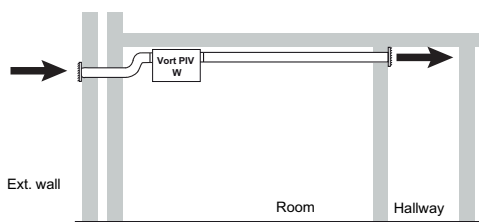

General warnings for the installer

NOTE: the official document to refer to is: "The Building Regulations: Approved Document F: Volume 1 applies to dwellings".

NOTE: the appliance **MUST** be mounted in the orientation of the chosen model (RH version, air flow to the right, or LH version, to the left): the version cannot be re-configured to the other version during installation.

NOTE: the appliance **MUST** be installed horizontally, on the wall.

NOTE: the appliance **MUST NOT** be installed in a vertical position or ceiling.

- The air outlet must typically be positioned in a central position in the apartment (eg in the hallway).
- The performance of the appliance can be improved if the air outlet is positioned above a heat source, for example a radiator.
- The air outlet must be positioned at least 1.8 m from the floor, at least 1 m from the heating thermostat and at least 1 meter from any CO₂ sensors or smoke detectors.
- The on-board heater should not be considered as a primary heating source for the apartment.
- The length of the inlet and outlet air pipes must be reduced as much as possible, compatibly with the configuration of the apartment. The pipes should preferably be rigid and the number of bends should be limited as much as possible.
- It is possible the formation of condensation on the air inlet pipe from the outside, in this case the use of insulating pipes may be useful.

Fig 7 to 12 (allowed and not allowed installations)

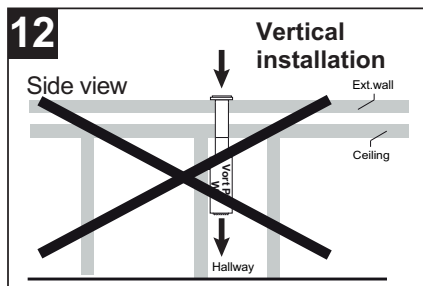
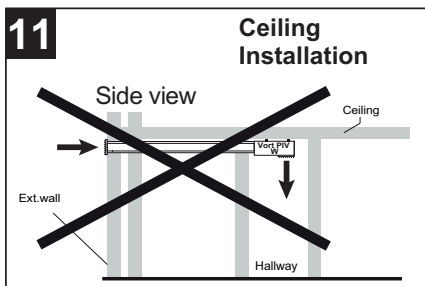
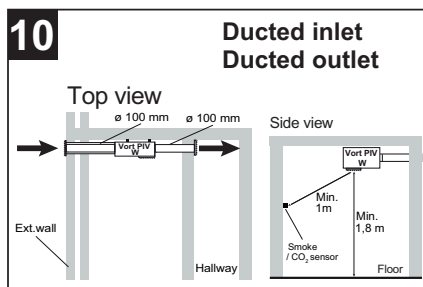
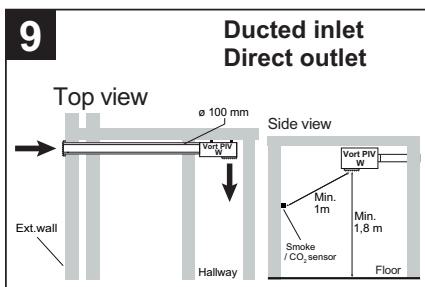
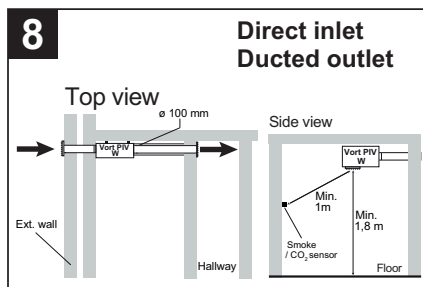
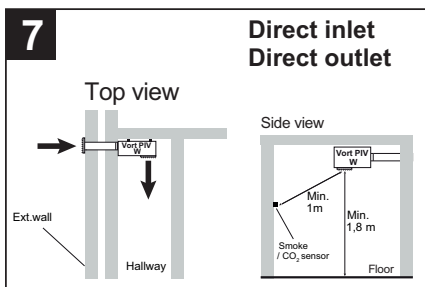

ENGLISH

Installation

Separate the appliance components as shown in fig 13

13

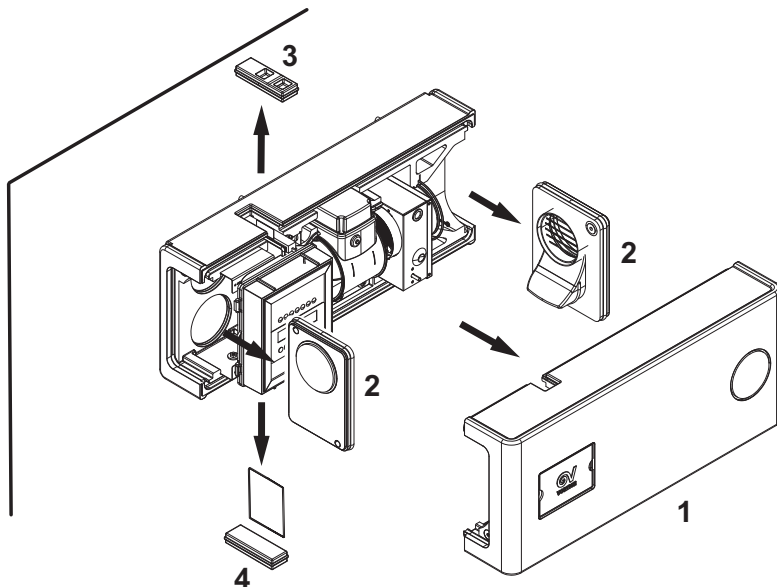

The template supplied must be used to drill the holes in the wall, for the 2 wall hooks. There are 2 fixing points for the appliance for the hooks (1, 2 fig 14). The template indicates the position of the holes for the RH and LH model (front and / back side of the template).

On the template: RH holes: □, LH holes: ▤
Fig. 14 represents the template of the RH version (the side b is for LH version).

14

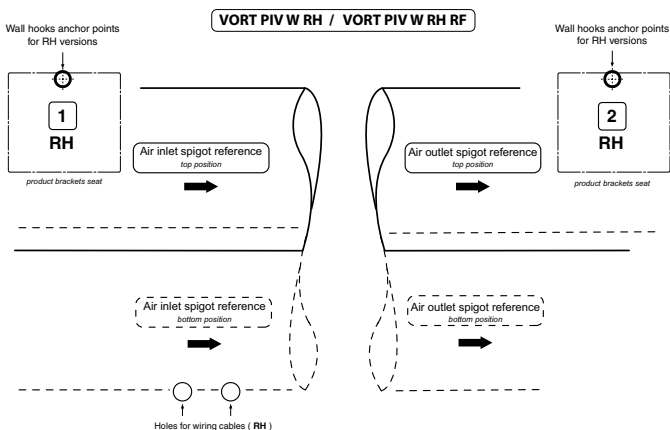

Code 5.071.084.007

ENGLISH

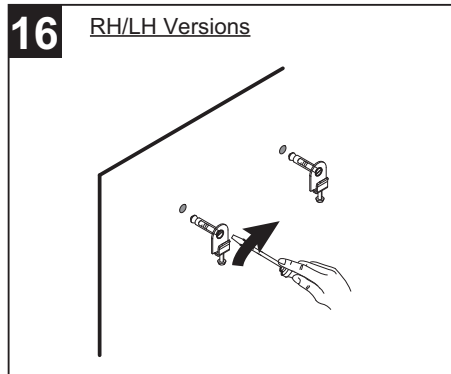
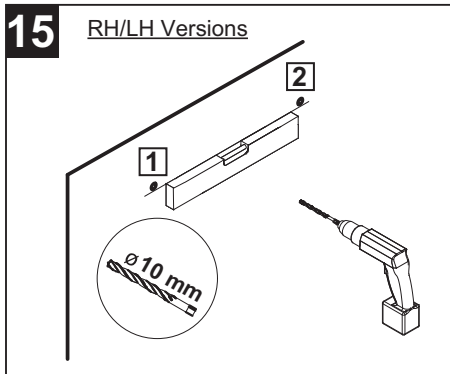
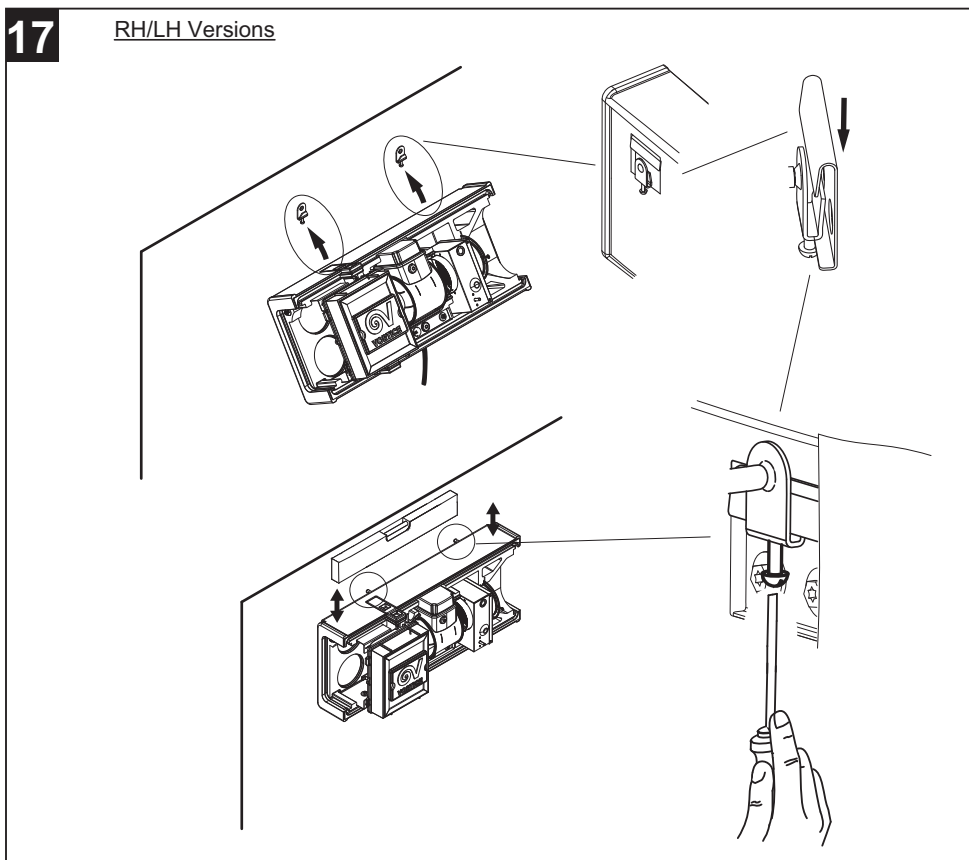

Fig.17: NOTE: the screw located in the lower part of the wall hook can be used to make a fine adjustment of tilting of the appliance, once it has been hooked to the wall.



ENGLISH

There is a third wall fixing point at the bottom of the appliance. Sequence of actions for making the hole: fig.18.

18a

RH Version

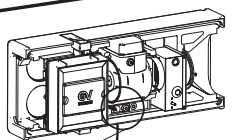

1

mark the position of the 3rd hole on the wall, breaking through the polypropylene wall of the appliance with a drill and a 6 mm bit

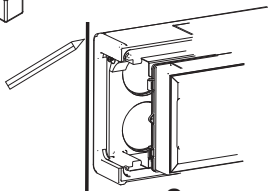

2

Mark on the wall the location of the appliance

LH Version

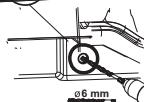

1

mark the position of the 3rd hole on the wall, breaking through the polypropylene wall of the appliance with a drill and a 6 mm bit



18b

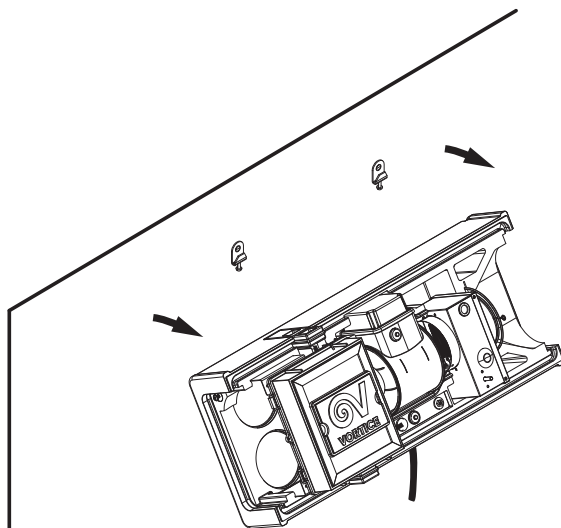

Remove from the hooks

18c

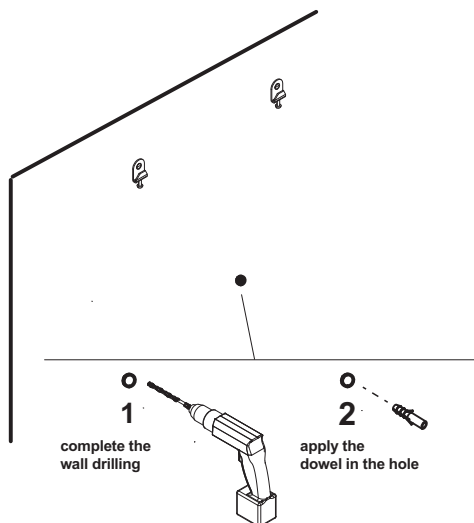

19

RH/LH Versions

the fused spur must always be an integrated component in the system

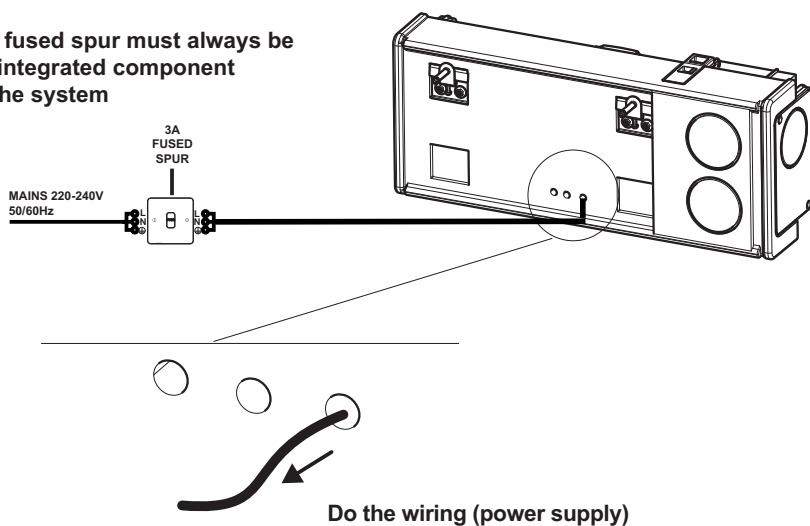

20

RH Version

In case of connection of a wired remote control

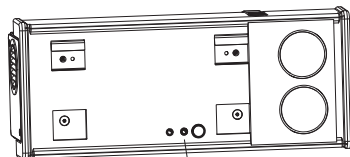
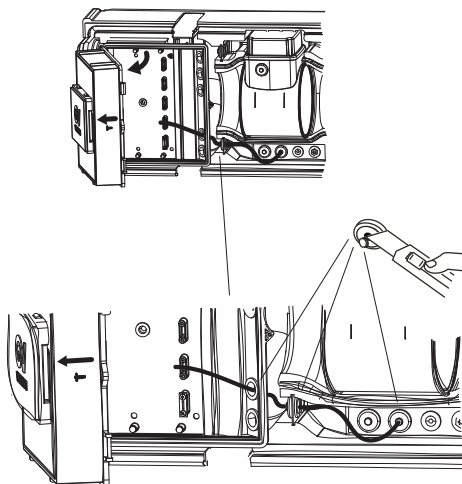

apply the cap B on
the cable exit hole

20b

LH Version

In case of connection of a wired remote control

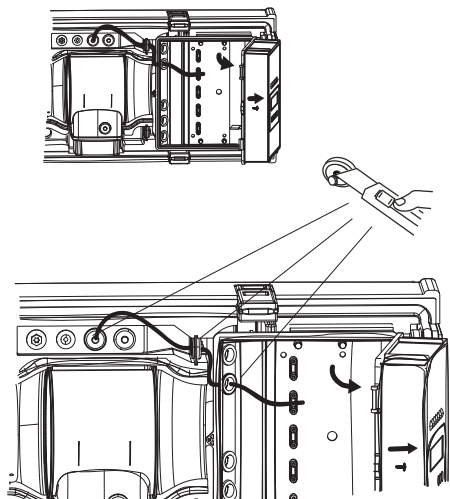

apply the cap B on
the cable exit hole

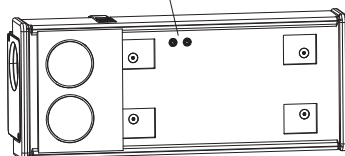

21

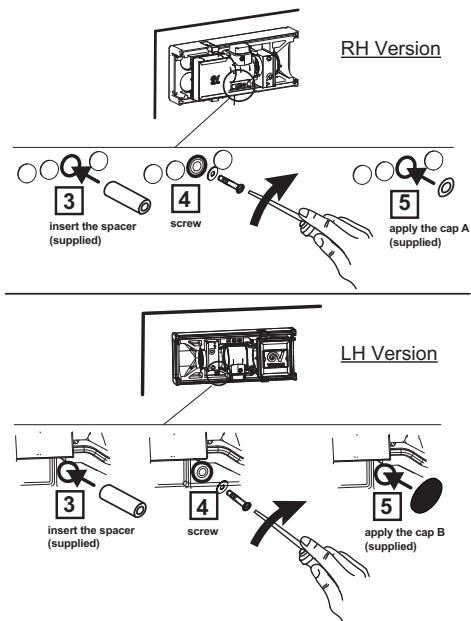
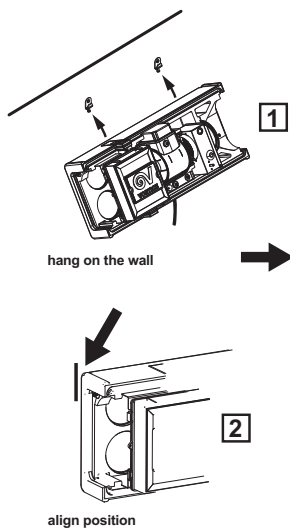

22

RH Version

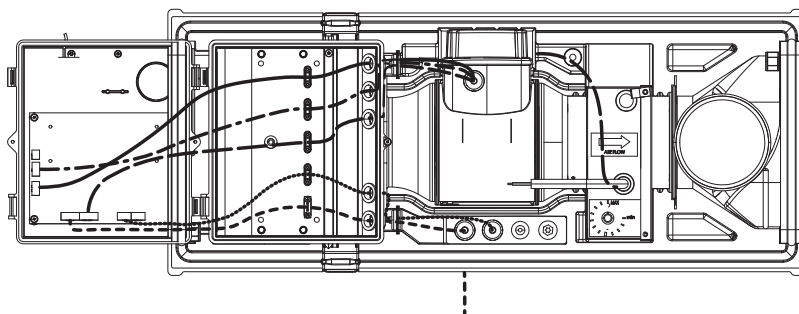

- WIRED REMOTE COMMAND
- - - - - MOTOR SIGNAL
- — — — — MOTOR SUPPLY
- - - - - HEATER SUPPLY
- POWER SUPPLY

22 b

LH Version

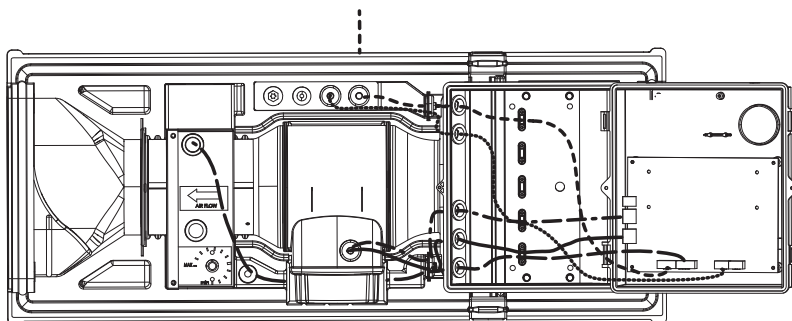

- WIRED REMOTE COMMAND
- MOTOR SIGNAL
- MOTOR SUPPLY
- · — · HEATER SUPPLY
- POWER SUPPLY

23

RH Version

RF MODELS

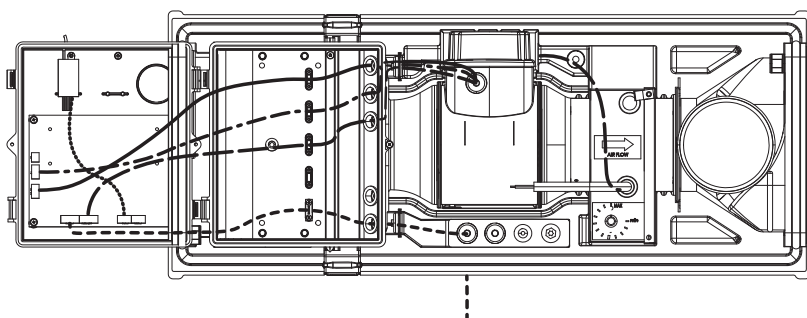

- RF MODULE
- MOTOR SIGNAL
- MOTOR SUPPLY
- · — · HEATER SUPPLY
- POWER SUPPLY

23 b

LH Version

RF MODELS

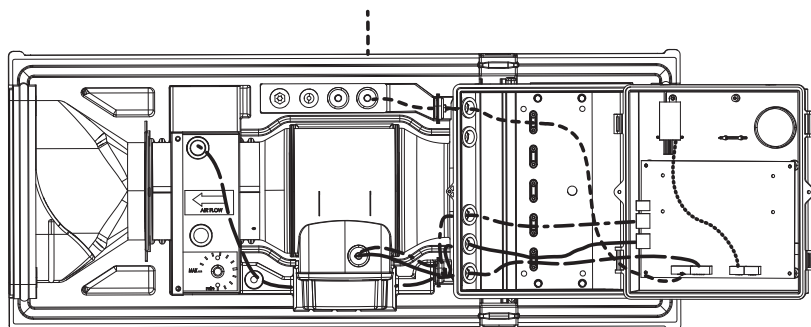

- RF MODULE
- MOTOR SIGNAL
- MOTOR SUPPLY
- HEATER SUPPLY
- . - . - POWER SUPPLY

24

Complete assembly
in the number sequence
of the components

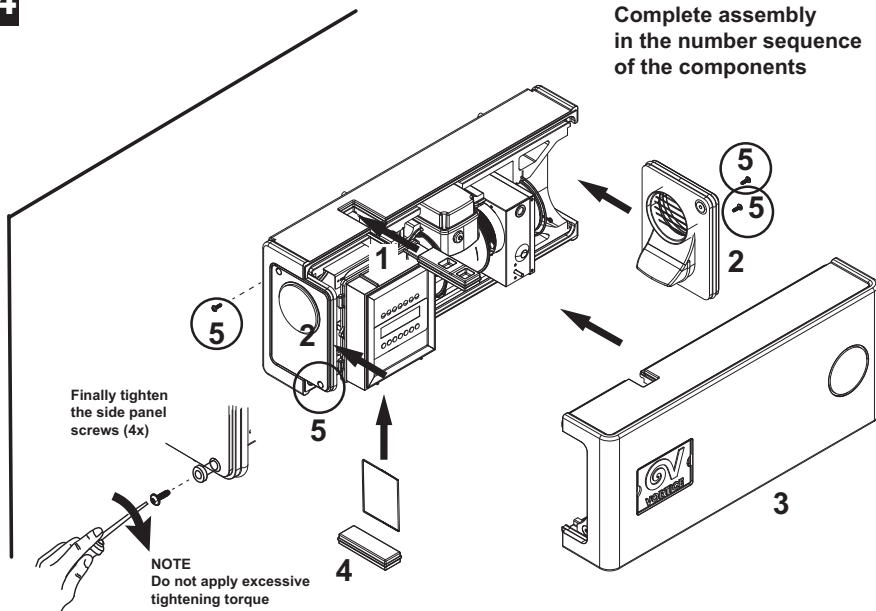

Commissioning

When turned on, pressing any key activates the control panel display (after 30 s of inactivity the display switches off saving the current settings). The display has two lines and is accompanied by a 7-key touch keyboard. The initial setting can be performed from the installer menu with the default access password "0000": one of the 4 Normal + Boost speed sets can be selected, according to the following combinations set in the factory (in compliance with the "Building Regulations") (refer to "Set Speed" under the "Configuration menu" section).

Setting	Number of bedrooms (see note 1 /note 2)	Normal speed [l/s] (note 3)	Boost speed [l/s]	Normal speed [m³/h]	Boost speed [m³/h]	Power Consumption (Heater OFF) [W] (note 4)	Power Consumption (Heater ON) [W]
1	one habitable room	13	19	46,8	68,4	6,8	506,8
2	1	19	25	68,4	90	9,3	509,3
3	2	25	31	90	111,6	13,2	513,2
4	3	31	36	111,6	133,2	17	517

Note 1: if the dwelling only has one habitable room, a minimum ventilation rate of 13 l/s should be used

Note 2: for each additional bedroom, 6 l/s are added to normal speed value.

Note 3: normal speed values can be modified in 1 l/s intervals.

Note 4: absorbed power at Normal speed with the G3(SOCoarse 30%) filter installed; power values referred to the unit with a new clean just installed filter.

These values are only referred to G3(SOCoarse 30%) filter configuration. In case of the replacement of this one with the G4(SOCoarse 60%) or F7(ePM2,5 70%) filter, due to pressure drops increases, the installer should fine-adjust the speed (see 'SPEED ADJUST' under "service menu") or choose a different speed setting in order to get the target airflow value.

Operation

The appliance is designed for continuous operation, with two speeds, Normal and Boost, which can be selected manually or automatically (e.g. with activation of the Boost speed by a smoke or presence or temperature sensor). Fire detectors already installed in the apartment can be connected to the device. In the event of a fire, the appliance will turn off automatically.

The device is equipped with a heater and an inlet air temperature sensor. This temperature determines the operating strategy of the appliance, which is based on three parameters:

T thresh.: input temperature threshold (default value: 21°C, modifiable by the User / Installer).

T summer: input summer temperature threshold: maximum operating temperature, when the threshold is exceeded, the appliance switches off (unless it's in mode Radon) (default value: 26°C, can be modified by the User / Installer).

T winter: input winter temperature threshold: when the temperature drops below the threshold, the heater automatically turns on (default value 10°C, modifiable by the User / Installer).

Parameter	Factory threshold value	Editable by installer	Range
T thresh	21°C	YES	19°C÷24°C
T summer	26°C	YES	24°C÷28°C
T winter	10°C	YES	5°C÷15°C

Depending upon the temperature of the drawn in air, the appliance will work in the four ways described hereafter.

Intake air Temperature	Behaviour	
> T thresh (*)	1. Normal speed increases by 10%.	
> T summer (**)	2. The unit will switch itself automatically to stand by mode, to avoid introducing too hot air into the building. "FAN STOPPED" signal appears on the display.	
< T winter	With the electric heater in OFF mode	3. The unit will switch itself automatically to stand by mode. "FAN STOPPED" signal appears on the display.
	With the electric heater in AUTO mode	4. The heater turns on

(*) In case the installer has set a temperature value of '24°C' both for "T thresh" and "T summer" variables, the unit will follow the behaviour 2. ("Fan stopped") when intake air temperature has exceed '24°C'.

ENGLISH

Heater

The on-board electronics does not manage the air outlet temperature, but the switching on/off of the heater (see "Use" section, "Heater" parameter). The temperature can be adjusted by manually acting on the heater (Fig 25: adjustments from MIN to MAX, the position MIN indicates the heater is off).

NOTE: the on-board heater should not be considered as a primary or secondary heating source for the apartment. A default value is set at the factory (about 10°C): in the winter period the heater will be active in 9-15% of the appliance operating time.

In case of overheating of the heater (for example in case of absence of air flow due to breakage or blockage of the motor fan), there are two intrinsic safety levels of the device:

- automatic reset safety thermostat;
- manual reset safety thermostat.

A first level of safety is given by the intervention of the automatic reset device: the thermostat automatically restores the heater operation. In case of failure of the previous thermostat, the manual reset device intervenes: the thermostat stops the operation of the heater and it can be reset manually using the Reset key (Fig.26). Before carrying out the heater reset operation, always disconnect the mains voltage. This operation must only be carried out by professionally qualified personnel.

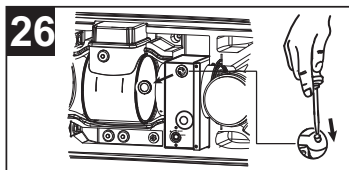
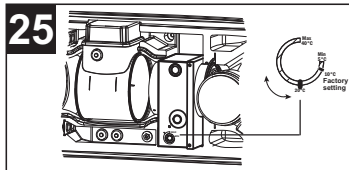

Appliance

There are 3 operating modes: Normal, Quiet, Radon:

- **NORMAL:** default automatic operating mode;
- **QUIET:** although the product is very quiet, the user can set an hourly interval (from xx: xx to yy: yy) within which the unit's operation in boost mode is disabled in order not to disturb the occupants. The user selects a time interval (from xx: xx to yy: yy) within which the unit never runs at Boost speed.
- **RADON:** this function allows for continuous operation, with the aim of eliminating traces of radon or other pollutants in the loft 24h / 24h.

In the RF models there is a radio controller that allows you to connect external radio devices (not Vortice), with which it is possible:

- to select normal or boost speed;
- to switch the 500 W heater to AUTO mode or OFF.

The operation of the appliance is controlled by a control panel with display.

The panel is on the front of the device, covered by a protective cover with the logo; it has a two-line display and 7 touch buttons (Fig. 27).

The panel allows the following actions: (see below for details: paragraph "Use")

User functions

- display and update of the current time;
- display and update of the current fan speed (from Normal to Boost);
- enable/disable the Heater
- display of the total operating time of the appliance from the first installation;
- display of the total operating time of the heater since the first installation;
- display of the remaining time before filter replacement;

Installer functions (with access password)

- selection of the desired speed set according to the type of apartment, among the 4 proposed and set in the factory (Installer).
- set a speed adjust (from -3 to +3 l/s) that applies to all the values of the speed sets;
- enable / disable of QUIET and RADON modes;
- set the Ts, Tsummer, Twinter values
- entering and changing the password for access to the Installation and Parameter Configuration Menu;

In the event of a power failure, when the mains is restored the appliance will restart at the normal mode speed ("Normal") corresponding to the speed setting previously selected.

The appliance is equipped with a battery which maintains the current time in the event of a power failure. Only in the event of a prolonged interruption (therefore with the battery flat) it is necessary to reset the time (see 'SET TIME' under 'Configuration Menu'). In any case, the appliance maintains the previously set configurations (for example: speed settings, QUIET or RADON mode selection).

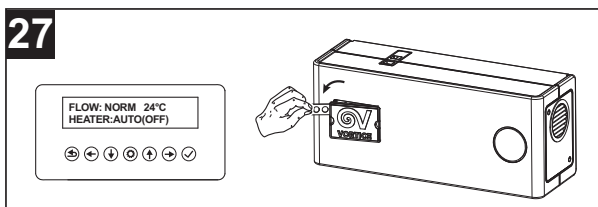

ENGLISH

Use

Meaning of the keys on the keyboard



- 1 ENTER:
 - enter the "edit" mode
 - save and exit "edit" mode
- 2 ARROW DX/SX:
 - shifting selection between the values of a parameter (in user mode "Edit parameters" and installer mode "Service")
- 3 ARROW UP/DOWN:
 - scrolling list of values or list of parameters
- 4 ESC:
 - exit without saving/return to previous screen
- 5 SET:
 - configuration menu

Home screen: switching on the appliance

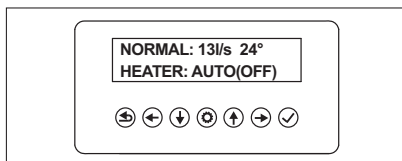

Display parameters

SPEED, HEATER and T°C (Home screen)



SPEED: 3 possible values:

- NORM
- BOOST
- FAN STOPPED (see "Behaviour" in Operation paragraph)

HEATER: 2 possible values:

- AUTO: the behavior of the heater is automatically adjusted. The current status, ON or OFF, of the heater, established automatically, is displayed in brackets: AUTO (ON) or AUTO (OFF)
- OFF: the heater is switched off

FILTER CHANGE IN

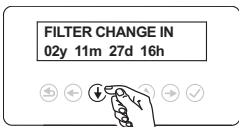

This screen visualizes the remaining time before filter replacement, expressed in Years/Months/Days/Hours. Refer to "Maintenance and Cleaning" section for the recommended filter replacement interval; the timer resets automatically when the filter is replaced.

OPERATION TIME

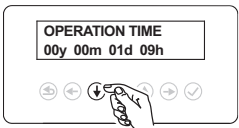

This screen displays the total operating time of the appliance since the first installation, expressed in Years/Months/ Days/Hours (Data Logger);

HEATER ON TIME

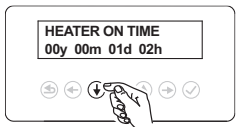

This screen visualizes the total operating time of the heater since the first installation, expressed in Years/Months/Days /Hours;

ENGLISH



TIME

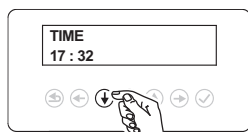

Display of the current time.

Edit parameters

SPEED

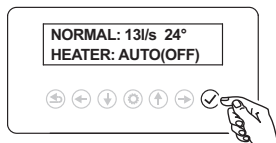

Press ✓ key to enter Edit Mode

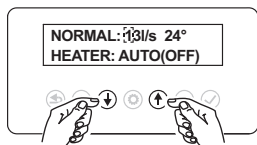

Press ↑ / ↓ key to select SPEED parameter

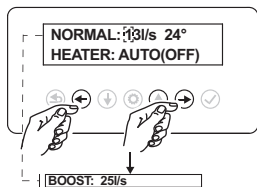

Press ← / → key to select the desired value (NORMAL or BOOST)

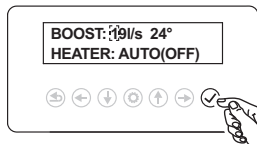

Press ✓ to Save and Exit

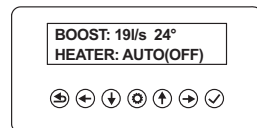

ENGLISH

HEATER

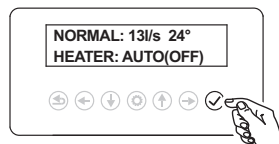

Press ✓ key to enter Edit Mode



Press ↑ / ↓ key to select HEATER parameter

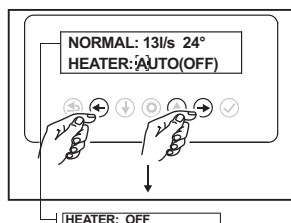

Press ← / → key to select the desired value

- AUTO: the heater is switched on or off automatically dependent on the set temperature parameters: AUTO(ON) / AUTO(OFF).
- OFF: the heater is switched off.

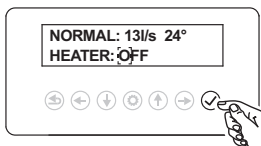

ENGLISH

Configuration Menu

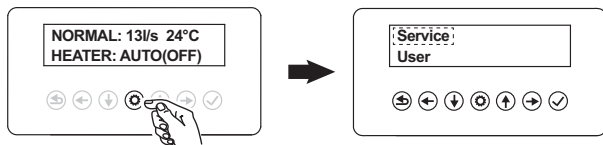

“Service” menu: this is password protected so you will require the unit’s password. If this is a new installation the default password is “0000”

“User” menu: this is not password protected

Service

Enter “Configuration Menu”

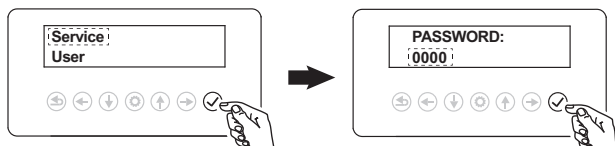

Enter Installer password: default “0000”

Service menu accessible functions:

- Set speed
- Speed adjust
- Set Quiet mode
- Set Radon mode
- Set Thresh. temp
- Set Winter temp.
- Set Summer temp.
- Reset filter
- Change password
- Set time

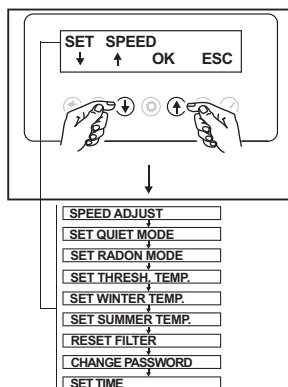

Press ↑ / ↓ key to scroll the functions list

ENGLISH

SET SPEED

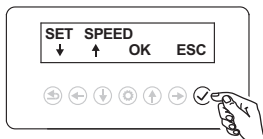

Press ✓ key to select the function required

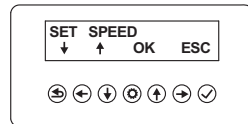
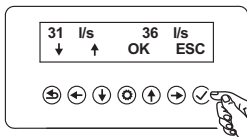
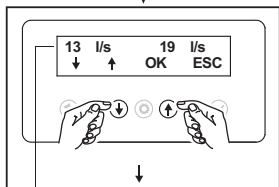

NORMAL	BOOST
19 l/s	25 l/s
25 l/s	31 l/s
31 l/s	36 l/s

Press ↑ / ↓ key to scroll through speed settings.

Press ✓ to confirm selection and Save / Exit

SPEED ADJUST

The normal (set) speed can be redefined by +3l/s to -3 l/s. The related Boost speed values will change accordingly.

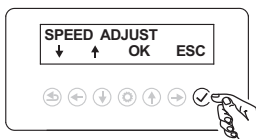
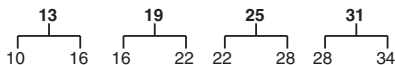

Press ✓ key to select the function required

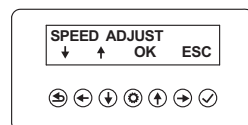
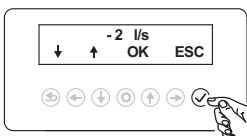
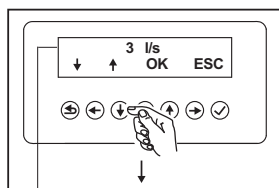

3 l/s	+
2 l/s	+
1 l/s	+
-1 l/s	-
-2 l/s	-
-3 l/s	-

Press ↑ / ↓ key to scroll through speed adjustment settings.

Press ✓ to confirm selection and Save / Exit

ENGLISH

SET QUIET MODE

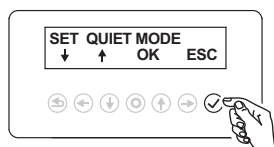

Press ✓ key to select the function required (Boost disabled)

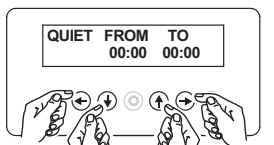

Press ↑ / ↓ keys to select the start hour of the quiet mode; then press → to move to the minutes and press ↑ / ↓ to select the minutes. Press → to move to the end hour of the quiet mode; press ↑ / ↓ key to select the end hour; then press → to move to the minutes and press ↑ / ↓ to select the minutes.

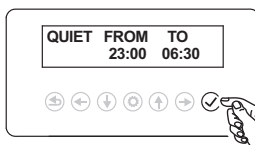

Press ✓ to confirm selection and Save / Exit

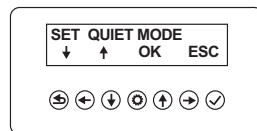

SET RADON MODE

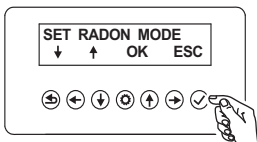

Press ✓ key to select the function required (Continuous operation)

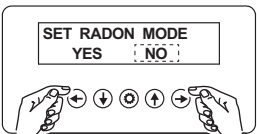

Press → / ← keys to select YES (on) or NO (off). NO (off) is the default setting.

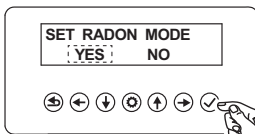

Press ✓ to confirm selection and Save / Exit

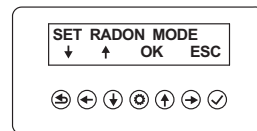

ENGLISH

SET THRESHOLD TEMP

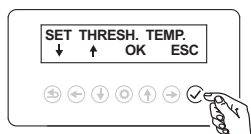

Press **✓** key to select the function required (input temperature threshold)
When the intake air temperature climbs above the set point, the normal speed of the appliance increases by 10%.

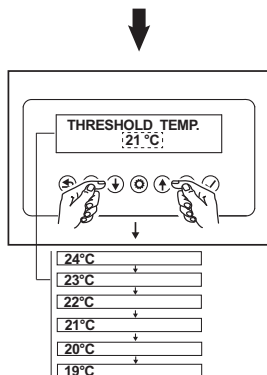

Press **↑ / ↓** key to scroll through temperature range 19°C to 24°C. (21°C is the factory default setting).

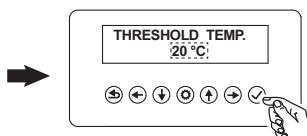

Press **✓** to confirm selection and Save / Exit

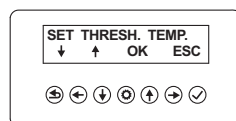

SET WINTER TEMP

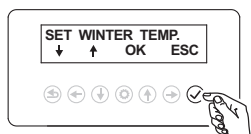

Press **✓** key to select the function required (winter temperature threshold). The winter temperature setting is the ambient temperature of the air within the loft space that will switch the post heater ON and OFF. When the loft air temperature falls to or below the set point the post heater switches ON. When the air temperature in the loft climbs above the set point the post heater switches OFF. The selectable temperature range is 5°C to 15°C with 10°C being the factory default setting.

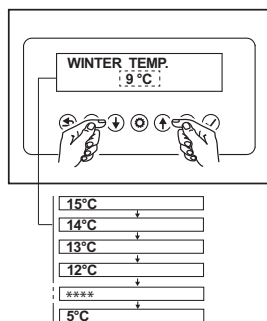

Press **↑ / ↓** key to scroll through temperature range 5°C to 15°C. (10°C is the factory default setting).

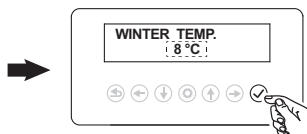

Press **✓** to confirm selection and Save / Exit

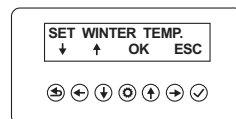

ENGLISH

SET SUMMER TEMP

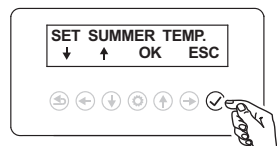

Press key to select the function required (summer temperature threshold). The summer temp(erature) setting is the ambient temperature of the air within the loft space which will when reached or exceeded, the PIV unit will go to standby mode until the air temperature within the loft falls below this point. The selectable temperature range is 24°C to 28°C with 26°C being the factory default.

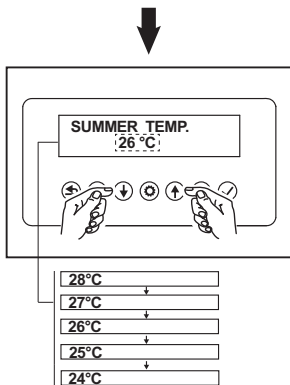

Press / key to scroll through temperature range 24°C to 28°C. (26°C is the factory default setting).

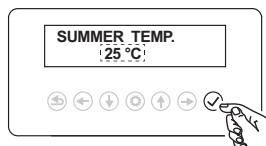

Press to confirm selection and Save / Exit

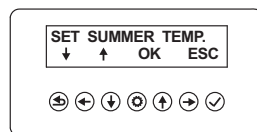

RESET FILTER



Press key to select the function required

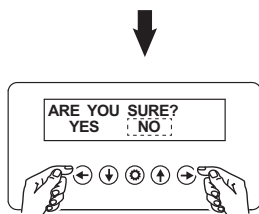

Press / keys to select YES (reset the counter to the start) or NO. NO is the default setting

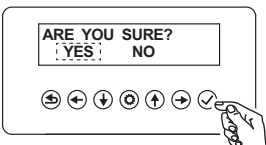

Press to confirm selection and Save / Exit

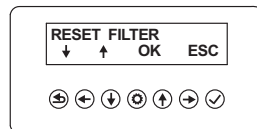

ENGLISH

CHANGE PASSWORD

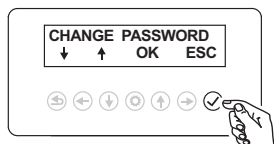

Press ✓ key to select the function required

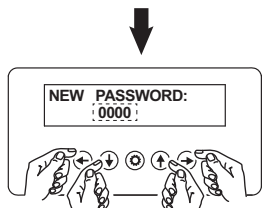

Press ↑ / ↓ keys to select the numbers of the password. Once the required number is reached press → to move to the next slot and use ↑ / ↓ to select the next number. Repeat this process until all four slots are full.

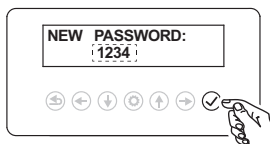

Press ✓ to confirm selection and Save / Exit

IMPORTANT: make a note of the password. If the password is lost contact your VORTICE dealer for the master password

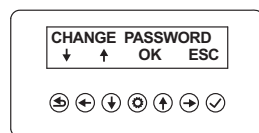

SET TIME

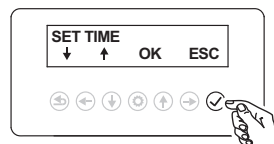

Press ✓ key to select the function required

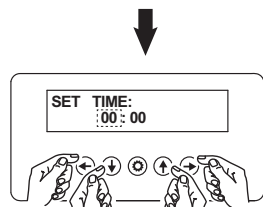

Press ↑ / ↓ keys to select the hour. Then press → to move to the minutes and use the ↑ / ↓ to select the minutes.

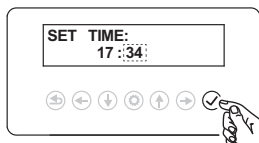

Press ✓ to confirm selection and Save / Exit

NOTE: the clock is in 24 hours format.

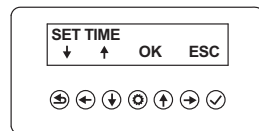

ENGLISH

User

The only user function which is settable is the time. This is not password protected.

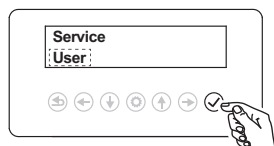

Press ✓ key to enter the "User" menu

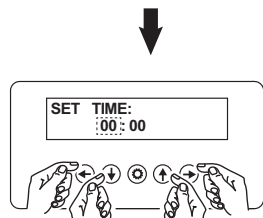

Press ↑ / ↓ keys to select the hour. Then press → to move to the minutes and use the ↑ / ↓ to select the minutes.



Press ✓ to confirm selection and Save / Exit
NOTE: the clock is in 24 hours format.

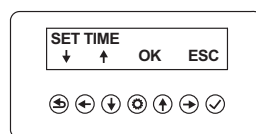

Maintenance and cleaning

Before carrying out any maintenance activities, it is necessary to disconnect the appliance from the power supply.

Appliance

Clean with a vacuum cleaner or with mild water and soap; do not use corrosive detergents.

Filters

The G3(ISOCoarse 30%) filter on board can be washed in the washing machine and must be replaced after 4/12 months of use (fig.28: G4(ISOCoarse 60%) and F7(ePM2,5 70%) are optional). Filter change interval refers to use in Normal speed mode; it is purely indicative, depending on environmental pollution condition and usage of Boost mode.

ATTENTION: do not use similar or theoretically equivalent filters without prior consultation and authorization from the manufacturer. In case of replacement with unauthorized filters, the original filtering capacity of the device is not guaranteed. ATTENTION: failure to clean or replace the filters causes problems for the efficiency of the system, with:

- increase in pressure drops in the air circuit and reduction in air flow;
- decrease in the performance of the appliance and worsening of comfort in the environment.

Battery removal (RF models only) (fig.29)

- 1) Remove the switch cover panel by hands or by using a screwdriver.
- 2) Remove the battery cover by means of a flathead screwdriver.
- 3) Remove the plastic protection and replace the old battery with the new one.
- 4) Reinstall the battery cover.
- 5) Reinstall the switch cover panel.

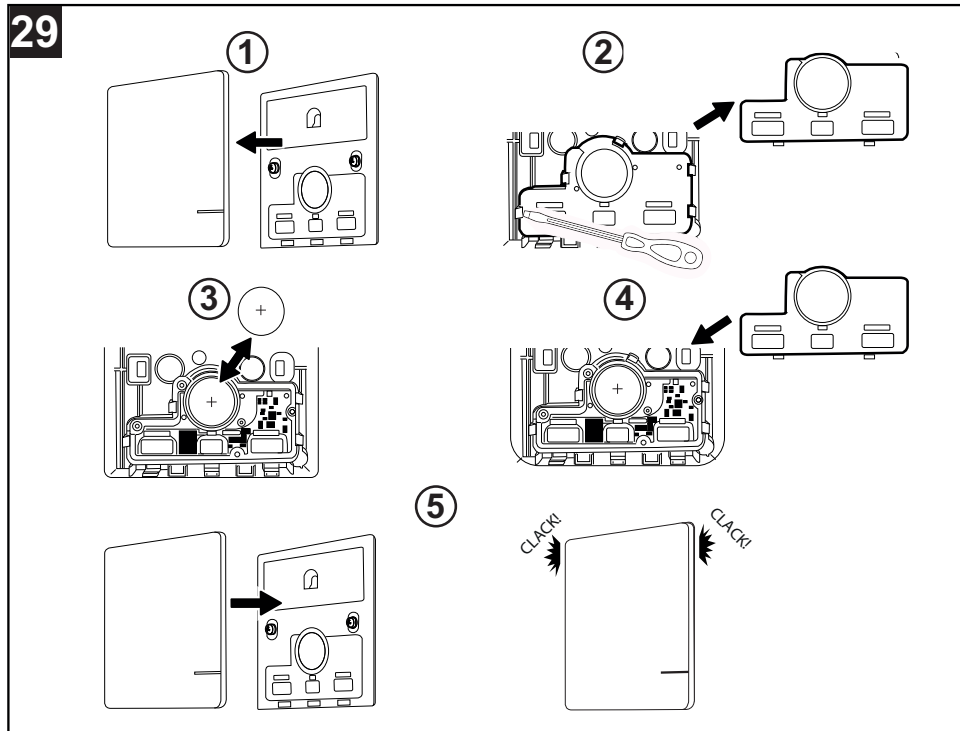
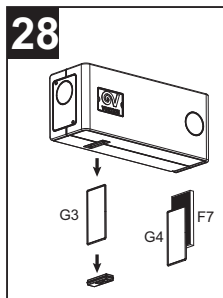

Available accessories

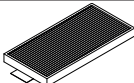
Code	Picture	Accessory name and description	Notes
20.383		FTR G4 PIV W	Refer to fig. 28 for filter installation
20.373		FTR F7 PIV W	Refer to fig. 28 for filter installation
46.188		TUBO CONNETTORE 100 MM (CONNECTOR PIPE 100 MM)	

Wiring diagrams

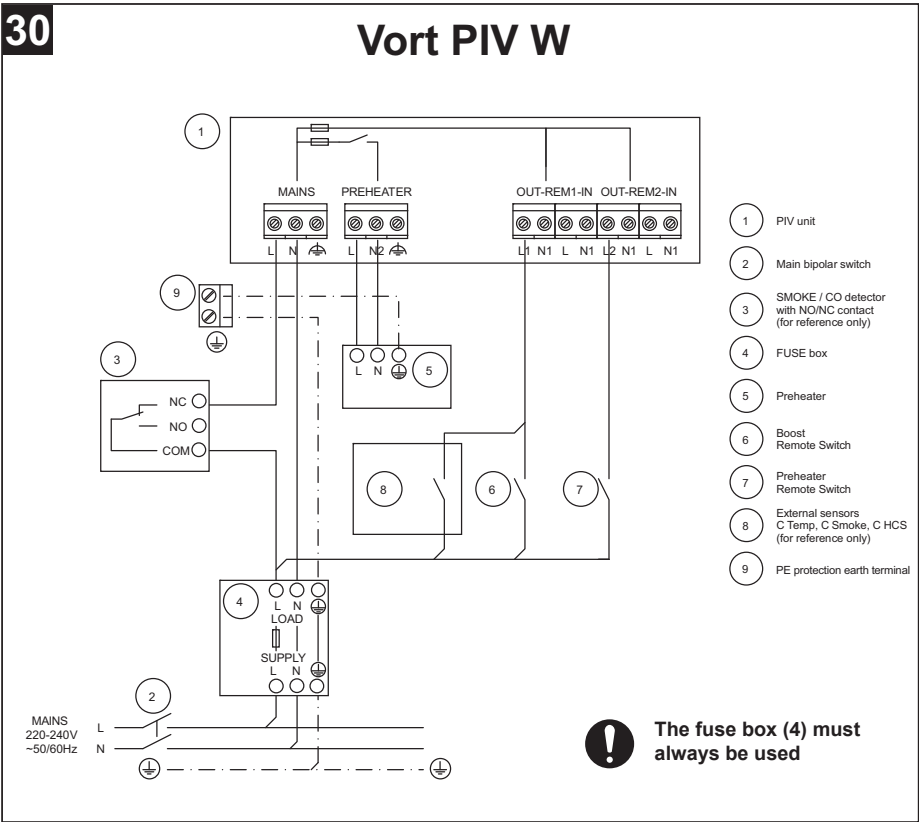

Vort PIV W RF

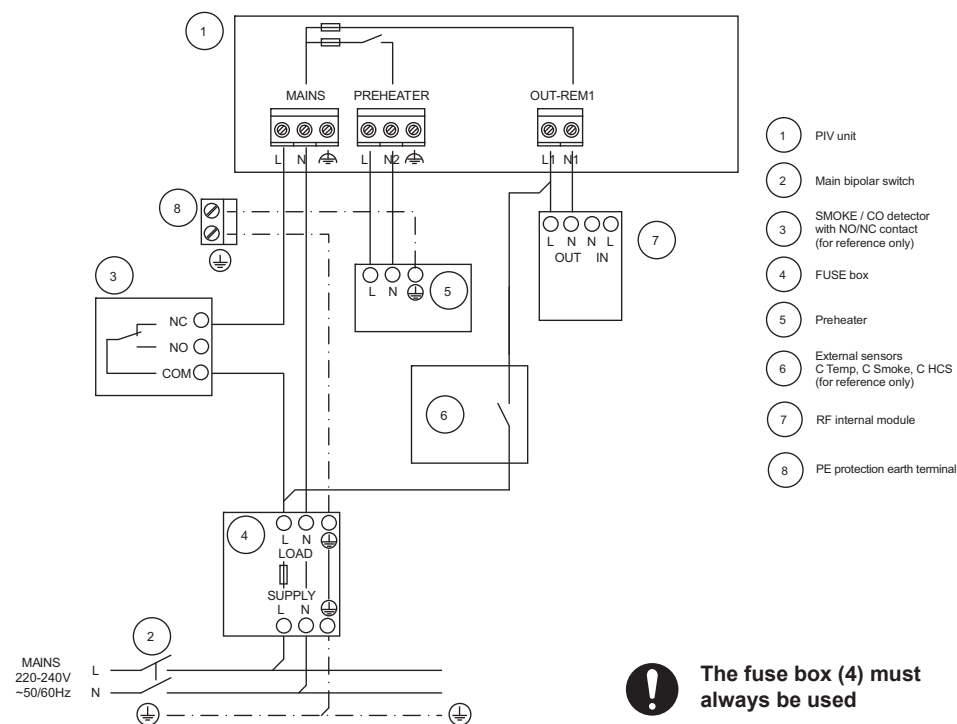

Troubleshooting

Problem	Possible cause	Corrective action
The electric heater is not functioning	The temperature is not detected	Heater thermostat is damaged. Contact the VORTICE Authorized Assistance Centre.
	Overheated heater resistance (e.g. in case of no airflow due to a fan motor breakage or blockage)	Check if the manual reset safety thermostat has intervened. Reset the thermostat by pressing the reset button (fig. 26) after checking that there are no fan motor faults. If this procedure does not work, contact an Authorized VORTICE Service Centre.
Range reduction of the air blown into the room or excessive noise	Improper installation of the diffuser or PIV unit system components	Verify that the installation of the PIV unit was carried out according to the instructions provided in this booklet.
	Possible clogging due to lack of cleaning the filter or replacing it within the recommended time frame (see "Maintenance" section).	Proceed to check the cleanliness status of the filter installed and its eventual replacement. Check that the filter is installed correctly and that there are no bulky materials in the attic covering the filter area.
Problems in the temperature detection	Temperature probe failure	Contact an Authorized VORTICE Service Centre and proceed to replace the probe.
The electric heater is not functioning	The intake air temperature is higher than the set value or T winter or it is not detected / intervention of the thermostat (automatic or security thermostat) on the heater.	1) Check the threshold value set for "T winter" in the "Service" menu. 2) The electric heater adjustable thermostat may have intervened (the temperature in the loft is higher than the preset value) 3) Check if the electric heater manual reset safety thermostat has tripped. In such a case, contact an Authorized VORTICE Service Center for assistance before resetting the thermostat (fig. 26). 4) Damage to the temperature probe: contact an Authorized VORTICE Service Centre.
Too hot air intake	Overheating of the electric heater resistance but ventilation unit still working	Possible damage to the thermostats on the heater: contact an Authorized VORTICE Service Centre.
Flow of the air interrupted	The motor fan may have broken or blocked.	1) Disconnect the unit from the mains. 2) Have the wiring diagrams of the unit checked by a specialized technician. 3) Breakage of the fused spur. Contact an Authorized VORTICE Service Centre. 4) Blockage or breakage of the fan motor. Contact an Authorized VORTICE Service Centre.
Reduction of the air flow introduced into the room or excessive noise	Incorrect installation of the diffuser or of the PIV unit components	Check that the installation of the PIV unit has been carried out following the instructions in this booklet.
	Possible clogging due to lack of cleaning the filter or replacing it within the recommended time frame (see "Maintenance" section).	1) Check that the filter is installed correctly and that there are no bulky materials that cover the filtering area. 2) Proceed to check the state of cleanliness of the installed filter and its eventual replacement.
Display is switched off but the ventilation unit is still operating	Broken display on the unit.	Contact an Authorized VORTICE Service Centre.

ENGLISH

Disposal

This product complies with Directive 2012/19/EU on the management of waste electrical and electronic equipment (WEEE).

The crossed-out wheeled bin symbol on the appliance indicates that, at the end of its useful life, the product must be taken to a specialised company for transport and treatment. This company will take care of the disposal of the various materials making up the product and their subsequent proper recycling.



Alternatively, the manufacturer of the appliance is obliged to take back the product to be disposed of in exchange for the purchase of an equivalent appliance.



VORTICE S.p.A. si riserva il diritto di apportare tutte le varianti migliorative ai prodotti in corso di vendita.
VORTICE S.p.A. reserves the right to make improvements to products at any time and without prior notice.
VORTICE S.p.A. se réserve le droit d'apporter toutes les variations afin d'améliorer ses produits en cours de commercialisation.
VORTICE S.p.A. behält sich vor, alle eventuellen Verbesserungsänderungen an den Produkten des Verkaufsangebots vorzunehmen.
VORTICE S.p.A. se reserva el derecho a hacer cambios en los productos para su mejora en cualquier momento sin previo aviso.
VORTICE S.p.A. 公司 股份有限公司 保留在产品销售期间进行产品改良的权利。

VORTICE GROUP COMPANIES

VORTICE S.p.A.
Strada Cerca, 2 - frazione di Zoate
20067 - Tribiano (MI)
Tel. +39 02-90.69.91
ITALY
vortice.com
postvendita@vortice-italy.com

VORTICE INDUSTRIAL Srl
Via B. Brugnoli, 3
37063 - Isola della Scala (VR)
Tel. +39 045 6631042
ITALY
vorticeindustrial.com
info@vorticeindustrial.com

VORTICE VENTILATION SYSTEM (CHANGZHOU) CO.LTD
Building 19, No.388 West Huanghe Road, Xinbei District,
Changzhou, Jiangsu Province CAP:213000
CHINA
vortice-china.com
vortice@vortice-china.com

VORTICE LIMITED
Beeches House-Eastern Avenue
Burton on Trent - DE 13 0BB
Tel. +44 1283-49.29.49
UNITED KINGDOM
vortice.ltd.uk
sales@vortice.ltd.uk

VORTICE LATAM S.A.
Bodega #6
Zona Franca BES Alajuela - Alajuela 20101
Tel. (+506) 2201 6934
COSTA RICA
vortice-latam.com
info@vortice-latam.com

CASALS VENTILACIÓN INDUSTRIAL IND., S.L.
Ctra. Camprodon, s/n
17860 - Sant Joan de les Abadesses (Girona)
SPAIN
casals.com
ventilacion@casals.com