

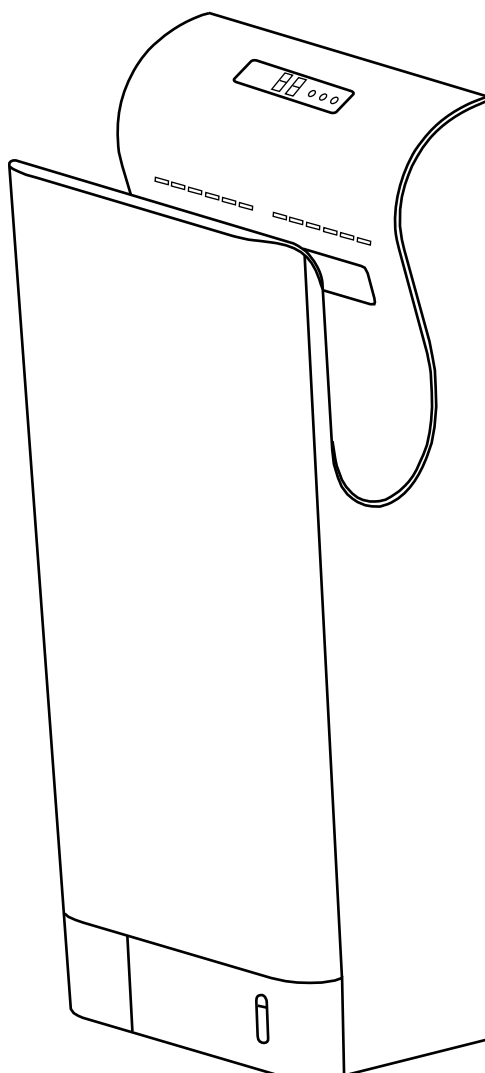

---

# VORT SUPER DRY UV

UK  
CA C €



## Features

- Drying hands without contact, it's hygienic
- Electricity cost saving because of drying hands at high speed
- It's economic & practical
- Anti-damage timer, use unworried
- Do not use towels & tissues, no dispose of waste
- Anti-bacteria & environmental material, no pollution
- Automatic heating, drying hands with comfortable in winter and drying
- Hands with cool in summer
- Automatic sterilization via filter

### Anti damage timer

Installed anti-damage timer, this machine will stop work after working 25 seconds. Draw out our hands and put again your hands into the dryer to continue use.

No need windpipe (fig.1)

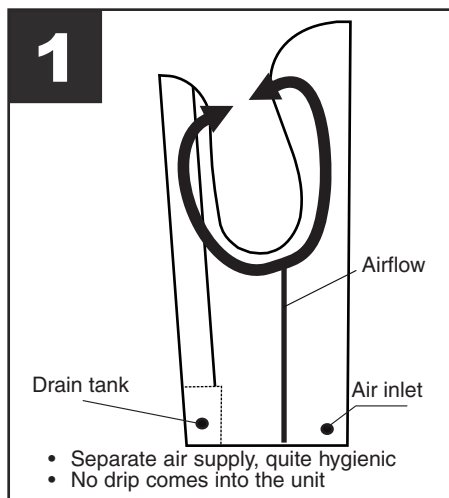

High and low sensors (fig.2)

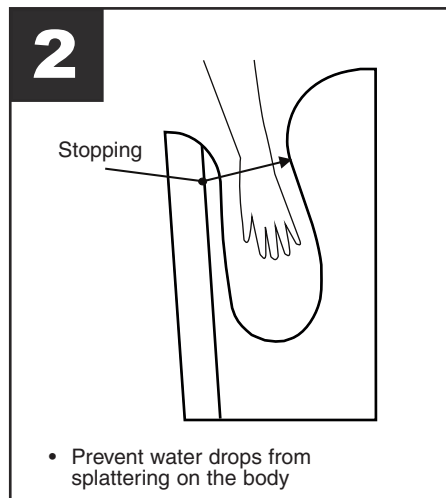

Ergonomic design (fig.3)



## Specifications

Rated Voltage	AC220-240V~	Motor	Brushless motor
Input power	1650-2050W	Induction method	IR blocking
Wind velocity	95 m/s	Protection class	IP24
Heating power	900-1300W	Dimensions	300X215X700
		Net weight	10,5 KGS

## Safety



### **Attention:**

**this symbol indicates that care must be taken  
to avoid injury to the user**

- Do not attempt to install the unit yourself unless you are a trained services technician. Otherwise, this may affect the safety and proper functioning of the unit.
- Read this manual thoroughly and carefully before beginning to use the unit, ensuring safety and proper function. Please keep it well for later reference.
- Do not open the front panel, otherwise this may get an electrical shock.
- Children forbidden hanging on the machine. There is risk of falling.
- Do not use in a wet environment, for example, near the bathroom where it may get the direct water and the places where the condensation may form, otherwise, this may cause electric shock and unit malfunction.
- Do not allow the unit get wet, otherwise, it will cause electric shock.
- Do not modify and disassemble the unit unnecessarily. Otherwise, this may cause a fire, electric shock, or personal injury.
- If the cord is damaged, it must be replaced by the manufacturer, its service agent or similarly qualified person in order to avoid a hazard.
- For additional protection, the installation of a residual current device (RCD) having a rated residual operating current not exceeding 30mA is advisable in the electrical circuit supplying the bathroom, ask your installer for advice.
- Installation of the appliance in bathrooms (where there are bath-tubs or showers) must be in accordance with current regulations.
- Rated power is required.
- This appliance can be used by children aged from 8 years and above and persons with reduced physical, sensory or mental capabilities or lack of experience and knowledge if they have been given supervision or instruction concerning use of the appliance in a safe way and understand the hazards involved.
- Children shall not play with the appliance.
- Cleaning and user maintenance shall not be made by children without supervision.



## Caution:

this symbol indicates that care must be taken to avoid damaging the appliance

- If power tolerance is over  $\pm 10\%$ , there will be breakdown. If using incorrect power supply, fire, electric shock and machine malfunction will happen.
- Please use dedicated socket if using together with other appliances, the socket may cause abnormal heat leading to fire.
- Power must be cut off when maintenance to prevent the risk of electric shock.
- Drain tank and air filter must be installed. Do not switch on after power connected for 10 seconds.
- If the machine doesn't work or have abnormal conditions, please cut off power to prevent accidents, and close leakage circuit breaker and ask supplier to check and repair, or it may lead to fire because of electricity leakage and short circuit
- It must have the reliable growing wire, otherwise it may cause electric shock risk when the unit failure or leakage.
- Attention when installation: do not install when the machine are power connected.
- It must operate by the professional construction person when install the unit. If the construction incorrect, it may cause electric shock and fire accident.
- Specifications for the power supply must correspond to the electrical data on data plate A. (Fig.A) (Fig. A).
- These appliances are designed for use in residential and commercial properties.
- The appliance must be installed by a professionally qualified electrician.
- The electrical system to which the product is connected must be in compliance with applicable regulations.
- An omnipolar switch with a contact opening distance of 3 mm or higher should be provided for installation, enabling complete disconnection under overvoltage category III conditions.
- Products equipped with three-phase wiring (T) engines ALWAYS require connection to 380-415V (or only 400V where required) three-phase lines, or also 220-240V (or only 230V where required).
- Any kind of modification shall be considered as product tampering and shall nullify the relative warranty.
- Products equipped with single-phase wiring (M) engines ALWAYS require connection to 220-240V (or only 230V where required) single-phase lines. Any kind of modification shall be considered as product tampering and shall nullify the relative warranty.

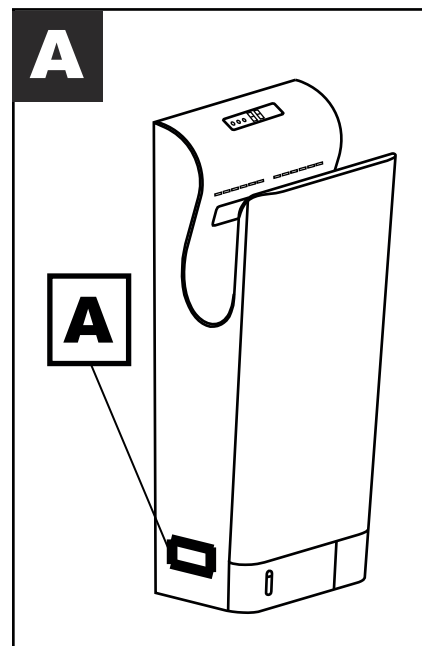

## Parts name and dimension drawing

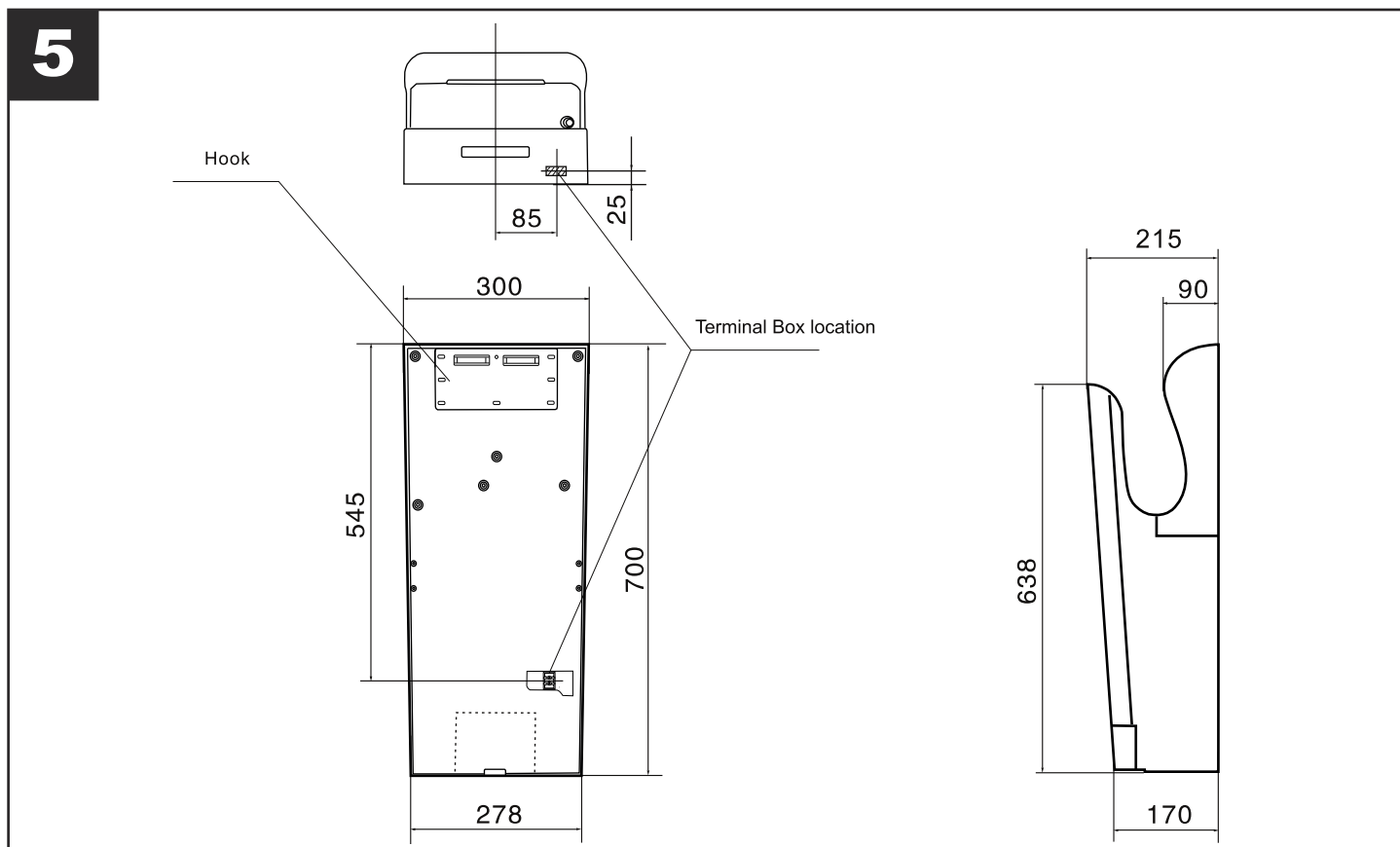
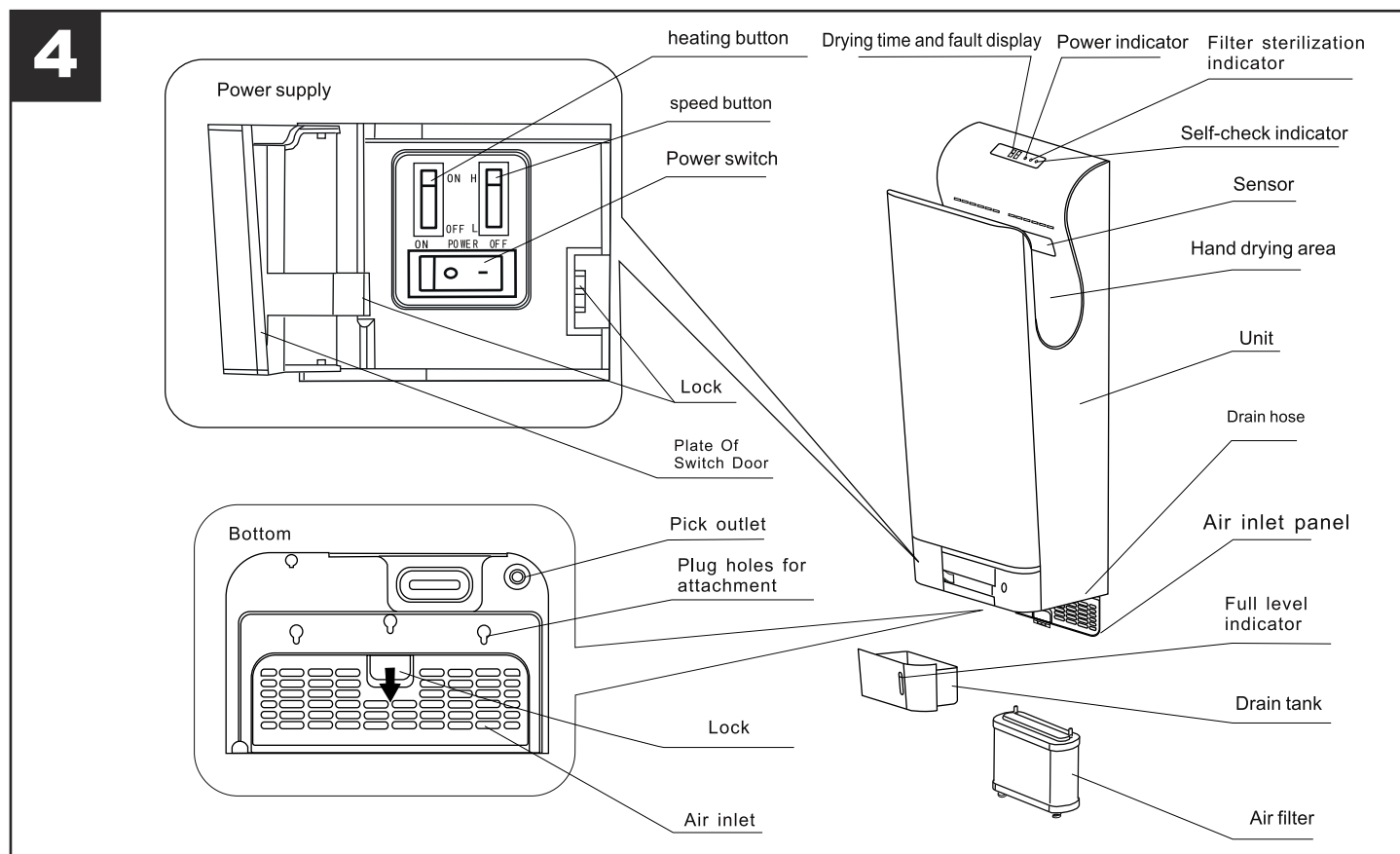

## Using the unit

See fig. 4:

- "Heating switch" button OFF:  
heating element off, for summertime operation;
- "Heating switch" button ON:
  - "Speed switch" button L: heating element always on;
  - "Speed switch" button heating element on if room T < 20°C, off if room T > 25°C.

- Stretch out both hands and insert them all the way in. The unit starts to run automatically. (Fig.6)
- Pull them out slowly, letting the air blow the water off. (Fig.7)
- Pull them out completely. (Fig.8)

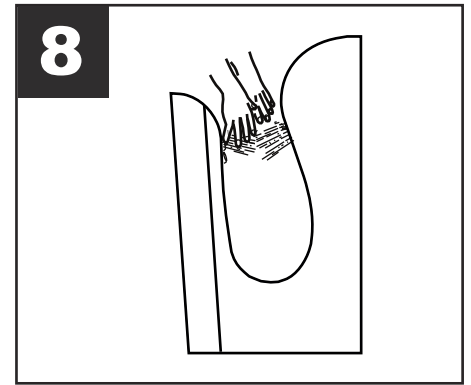
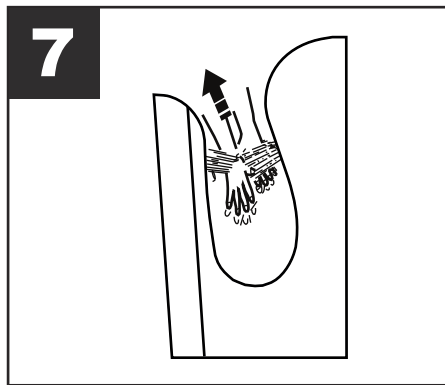
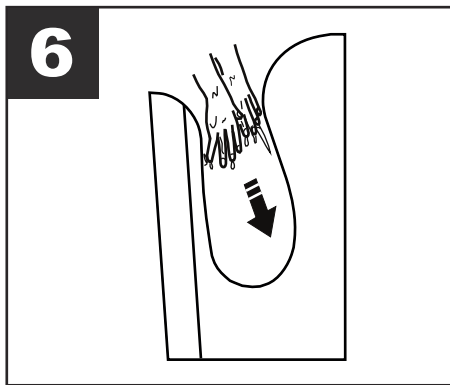

### Self-check indicator

When a malfunction or error occurs, the self-check indicator on the right side will either light up or flash. Turn off the power switch, wait about 40 seconds until all the indicators go off, then turn on the power switch. If the indicator still lights up or flashes, turn off the power, disconnected the unit from the socket, and contact your dealer immediately.

### Usage label

Stick the usage label on the visible place (the front of the unit or the wall nearby) (Fig.9)

### When using the unit:

- Turn on the power switch
- The power indicator lights up
- The lamp lights up
- The cover of power supply is closed

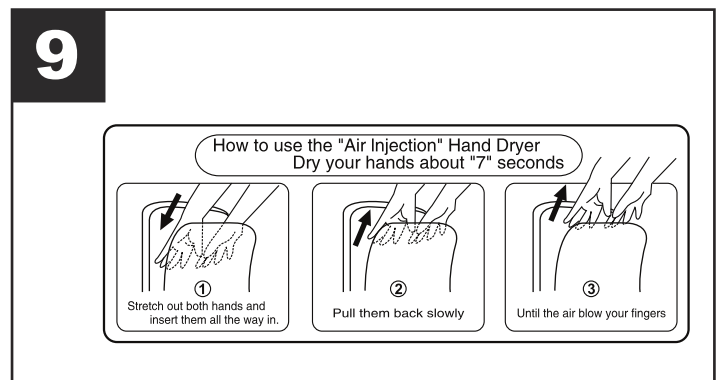

## Maintenance/cleaning

### WARNING

- Before you clean the unit turn off the power switch.
- Do not splatter water on the unit.

### CAUTION

- Wear gloves when cleaning.
- The antibacterial coating is effective when the bacteria exposed the coated surfaces.
- The antibacterial coating becomes not effective when the surfaces get very dirty.

### Cleaning the unit body

before it gets obviously dirty:

- Clean the unit with a soft cloth. If the unit get very dirty, clean with a soft cloth dampened with neutral agents, then clean with a dry soft cloth.
- Remove the dirt from sensor. (to prevent malfunction).
- Only use the neutral cleaning agents.
- Do not use thinner, acidic or alkaline toilet cleaners, or nylon brush. Only use the alcohol to clean the hand drying area. (Do not use the alcohol anywhere else) [Alcohol here means the alcohol used for disinfection (Concentration below 83%).
- If the chemical cloths used please read their instructions first.
- Disinfecting agents will damage your unit.

### Draining and cleaning the drain tank

(fig.10)

before it fills up (at least once a week):

The water blown off the hands in called" drain water"

- Empty the drain water at any moment, in order to prevent Accumulated water from exceeding the full level
- It will start smelling if the accumulated water remains in the tank for too long time.

Pull the drain tank out in the Horizontal direction.

This ensures the drain water does not splatter out.

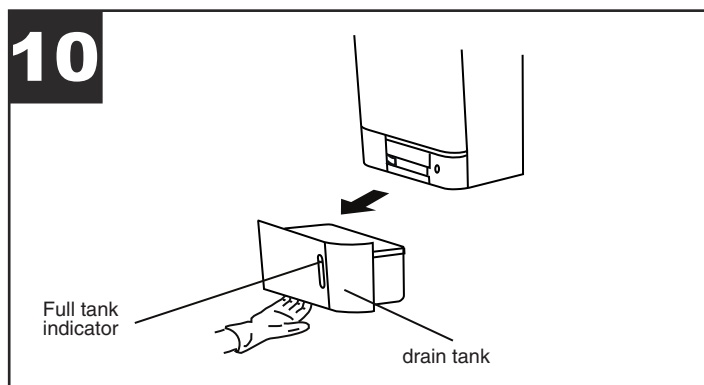

(Fig.11)

Open the cover and empty the water

- Pull the cover upwards by taking hold of it at the two corners and then removing it completely

(Fig.12)

- Wash out the interior of the drain tank

(Fig.13)

- Close the tank cover before you put it back into its position

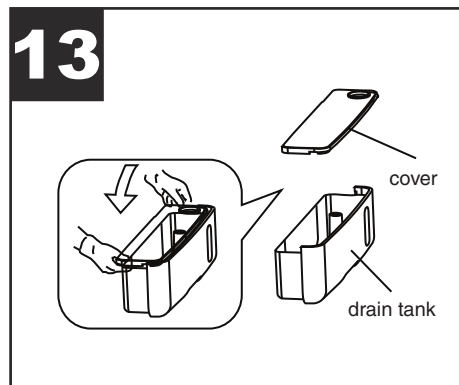
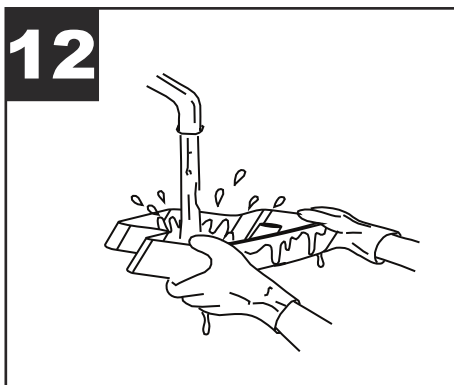
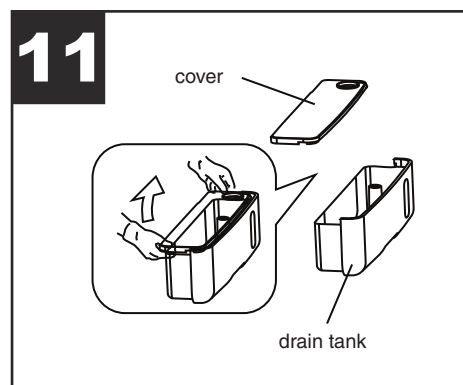

(Fig.14)

- Add 200cc (around 1 cup) of water through the drain hole.
- Use the unit after confirming that the water tank is in place

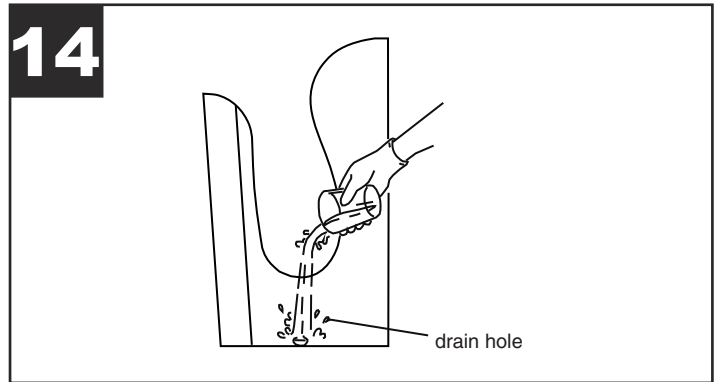

(Fig.15)

## Cleaning the air filter

Around once a week

Remove the air filter

- Pull the air filter out by the handle
- Remove the prefilter from the filter

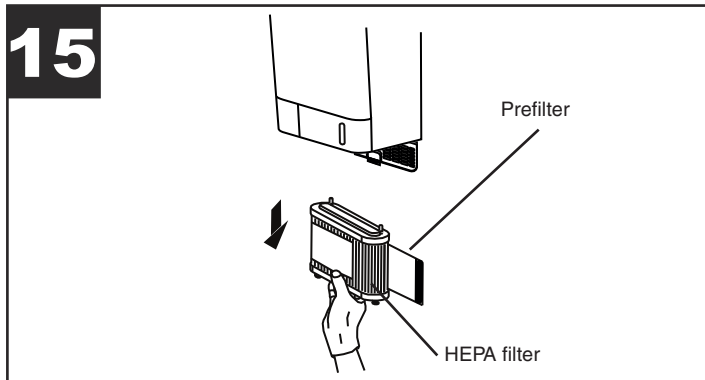

(Fig.16)

## Cleaning the air filter

- beat it lightly by hand or use a vacuum cleaner.
- if it is very dirty, wash it off with cold or warm water
- Same as the filter, if the prefilter is very dirty it can be washed with cold or warm water

## Re-attach to the unit

- Close the prefilter around the filter before insert it.
- insert it all the way in, until it stops (if it is not in place, the dirt or dust will enter the unit and shorten its service life)

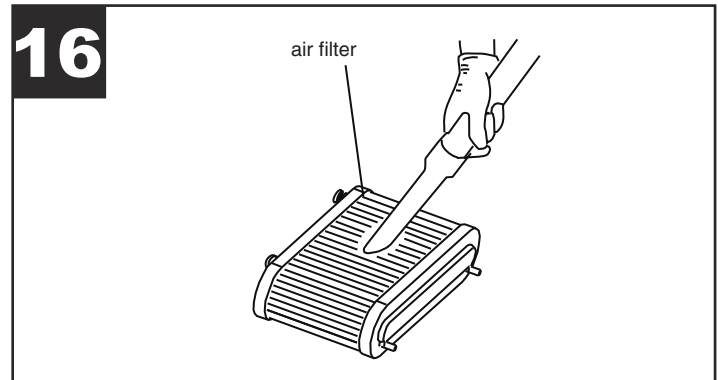

## NOTE

If you wash the air filter or prefilter with water, dry it as much as possible.

Do not expose to the fire



## Troubleshooting, electrical schematic

If you discover the following circumstance, please inspection and handling as following:

Problem	Check	Action
No air blows even if hands are inserted	<ul style="list-style-type: none"> <li>Do the display indicators lights up?</li> <li>Is the power switch on?</li> <li>Are you putting your hands all the way in?</li> </ul>	<ul style="list-style-type: none"> <li>• Turn the ground-fault circuit breaker on.</li> <li>• Turn the power switch on.</li> <li>• Put hands all the way in.</li> </ul>
Machine works long time after hands drawn out. finally shows E2	<ul style="list-style-type: none"> <li>• Any dirt or foreign body on sensor?</li> </ul>	<ul style="list-style-type: none"> <li>• Switch off the power button, and then remove dirt or foreign body on sensor after the power light gone out; when finished, switch on power button.</li> </ul>
No hot wind	<ul style="list-style-type: none"> <li>• There is a built-in heater in the unit. Any dirt on heating sensor?</li> <li>• Fuse inside terminal box blown?</li> </ul>	<ul style="list-style-type: none"> <li>• Is the ambient temperature higher than 20°C?</li> <li>• Switch off power, remove front cover, there is a terminal box inside, take down the cover of terminal box. check the fuse inside box which is blown or not</li> </ul>
Airflow is too low	<ul style="list-style-type: none"> <li>• Is the speed button on low level?</li> </ul>	<ul style="list-style-type: none"> <li>• Put speed button on the high level.</li> </ul>
If the above actions do not work, turn off the power and the ground-fault circuit breaker, and call your dealer to inspect and repair it if necessary.		

Electrical schematic (Fig.17)

17

## Electrical schematic

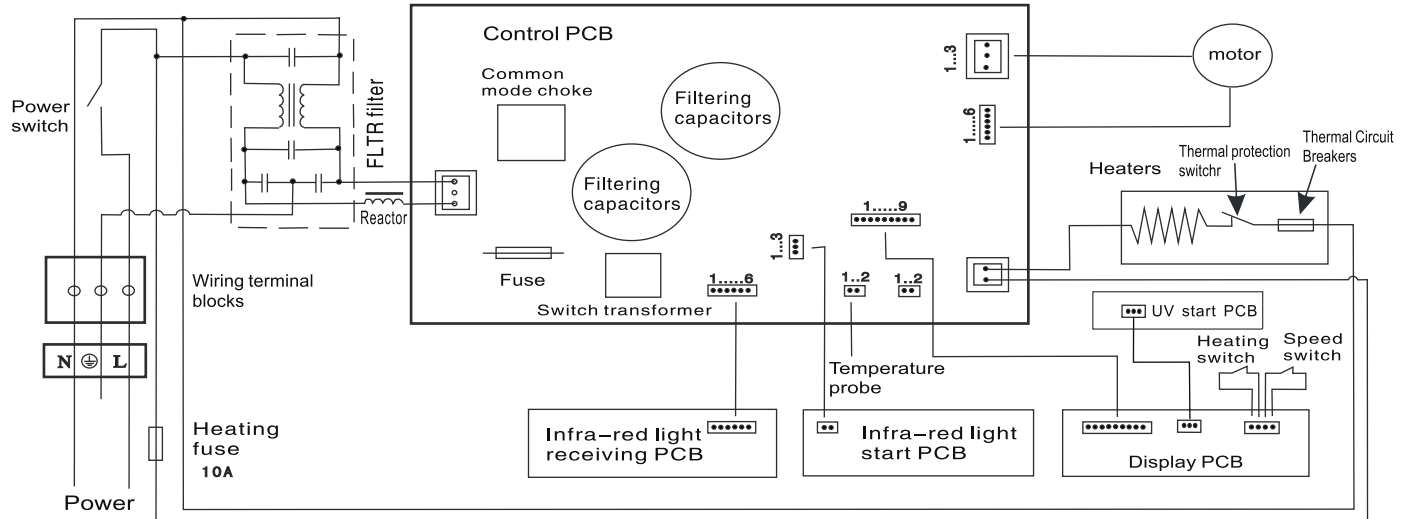

	Status	Introductions	Status	Introductions	Solution
Power indicator light	Light	Power input normally	Extinguish	Power not supply	Check the external power source, close the power switch
				Master board fuse blew out	
State indicator light	Extinguish	Don't work	Flashing light	Motor fault, it can't start normally	Check motor connecting wires and the rotor foreign material
	always light	Working		Trick or working time longer than 25s	
Sterilization indicator light	Light	UV Emission platedisinfest sterilization start work after machine power on(one hour), thereafter once a day	Extinguish	Sterilization work has ended	Turn off the power, re-power After LEDs are off, Sterilization indicator is still not lit. Please check the UV Emission plat.
				UV Emission plate error	
Timing digital tube	Digital changes	Countdown work	Jump display	Indicate drying time finished	
	E1	Motor fault, it can't start normally	E2	Trick or working time longer than 25 seconds	Clear workspace foreign material, restart to work
	E3	The voltage exceeds 15%	E4	The voltage lower than 15%	Check the power supply circuit
	E5	Machine temperatures higher than 80℃	E6	Master board temperatures higher than 80℃	Clear the foreign material of the air inlet and air outlet
			E8	Fan fault	Check whether the Fan sensor connect is loosen

## Precautions before installing

Do not install in the following types of locations, otherwise this may cause malfunction:

- Locations where the temperature can exceed -10°C or 40°C
- Locations where the unit may come into direct contact with water
- Locations where the unit is under direct or strong sunlight
- Locations where there is a lot of condensation
- Locations where corrosive, neutral, or reductive gases are present
- Places lower than -20°C or higher than 2000m above sea level

### Installation location

- Install somewhere the unit will be easy to use, as shown in the figure.  
If the unit is installed too low, water may get on it when the floor is being cleaned.
- The space between the base and the floor or any obstacle must be greater than 150 mm, because the electric box is located on the bottom of the appliance.
- Check on both sides of the appliance that there are no mirrors or walls, because drops of water could be sprayed to the right during use. (The recommended distance is at least 100 mm).
- Avoid locations where people or doors might bump into the unit
- Choose a completely flat surface on the wall to install the unit
- Places lower than -20°C or higher than 2000m above sea level

### Power Supply

- The power supply should preferably be via a plug: install a three-hole socket outlet on a side wall at least 20/30 cm from the appliance.
- Direct connection to the electric line: use a connection box without a cover.

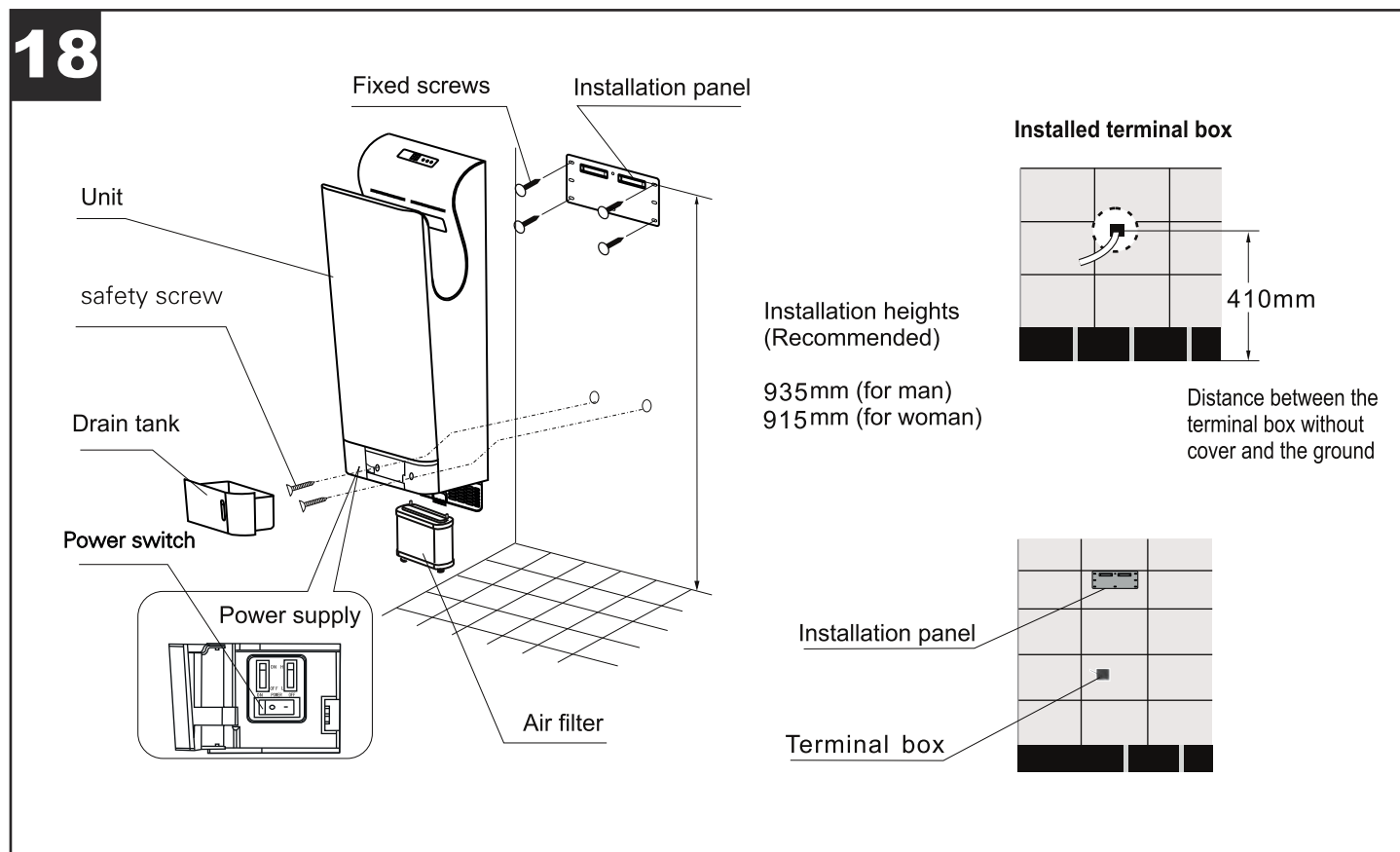

## Installation

### N.B.

If the unit is equipped with a plug ignore the instructions describing the electrical connections.

- Use a single-phase alternating rated voltage supply, (Do not used with a power supply exceeding rated voltage  $\pm 10\%$  ).
- Use a power cord which is between 2 mm<sup>2</sup> and 2.5 mm<sup>2</sup> thick, (Cords other than 2mm<sup>2</sup> - 2.5 mm<sup>2</sup> single-core cords cannot be used).

(A drop in voltage is possible if the power cord exceeds 11m in length, so we recommend using a 2.5mm<sup>2</sup> cord.).

### Wire the unit

(Fig.19)

Embed the switch box in the installation location (1 switchbox no cover)and wire the power cord (with the green and yellow combined is ground line).

- If no switchbox is used, the power cord will be pushed out, and prevent the unit from being installed firmly against the wall.

### Attach the installation panel to the wall using the 6 installation screws.

(Fig.20)

- If the wall is concrete, use commercially available metal screw plugs(curl plugs, etc.)
- If the wall is not concrete, reinforce it before installation.
- Place the drilling stickers on the wall and drill the holes.
- Insert the wall plugs into the holes and fasten the mounting plate as shown in the figure.

### Remove the drain tank and the filter (Fig.21)

- When installing with a plug, continue from Fig. 25;
- For direct connection to the electric line, continue from Fig. 22;

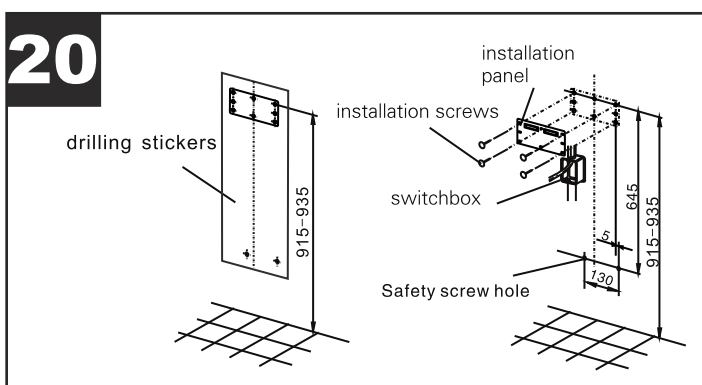
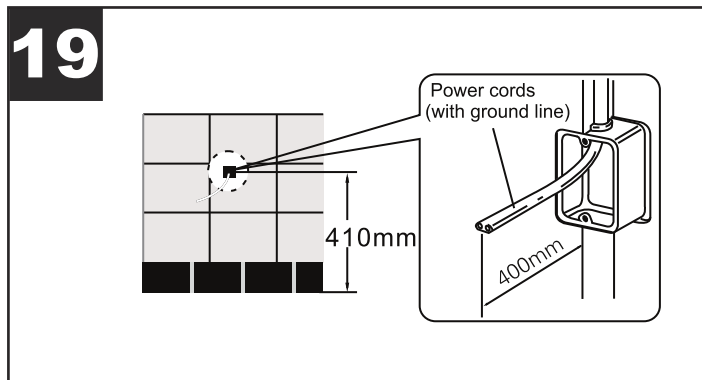
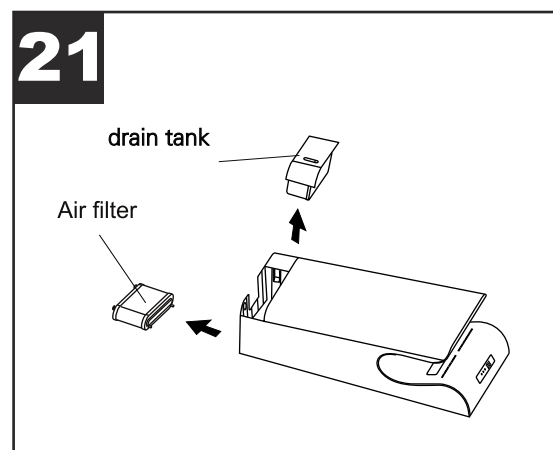

### Take the cover off the electric box and take the cables (Fig. 22);

- unscrew the two screws of the cover; open the cover;
- unscrew the two screws of the cable gland and the 3 screws of the terminal board; take the cables.

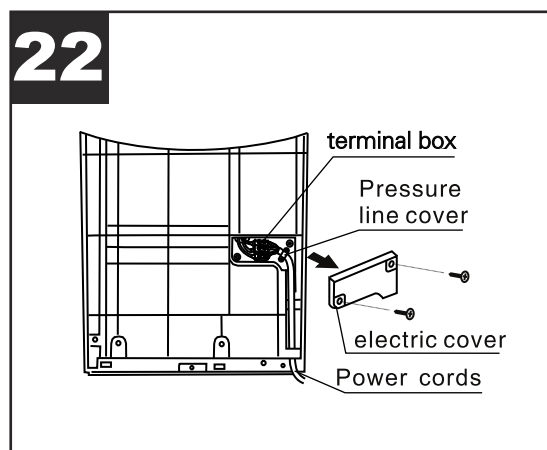

(Fig.23)

## Insert the electric cable provided into the appliance

If you would like to change the cable, proceed as follows:

- raise the appliance to a height of at least 250 mm; make both connections (in the appliance and in the wall) at the same height, by performing the following tasks:
  - a. strip the cable
  - b. connect the cable to the terminals inside the appliance
  - c. tighten the screws of the terminal board
  - d. secure the cable by tightening the screws of the cable gland

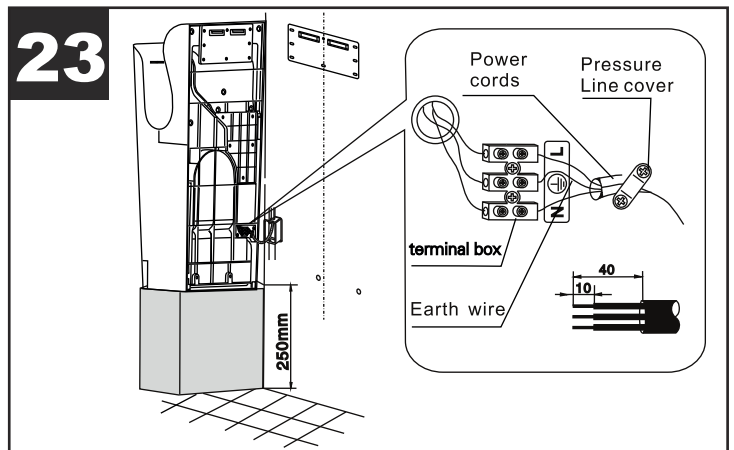

(Fig.24)

## Install the electric box cover

- Place the cover and secure it with the screws.
- Make sure that the cables are not squashed

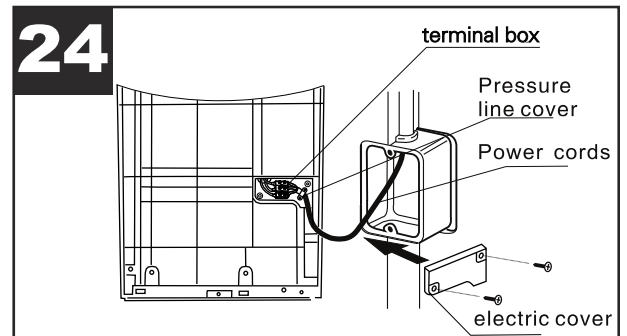

(Fig.25)

## Secure the appliance

- Gather up the excess cable and insert it into the electric box in the wall.
- Hook the appliance onto the wall panel and make sure it is firmly inserted on the hooks and lying against the wall.
- Apply the two vandal resistant screws.

### NOTE

The appliance must be installed with the vandal resistant screws, otherwise it may be subject to theft.

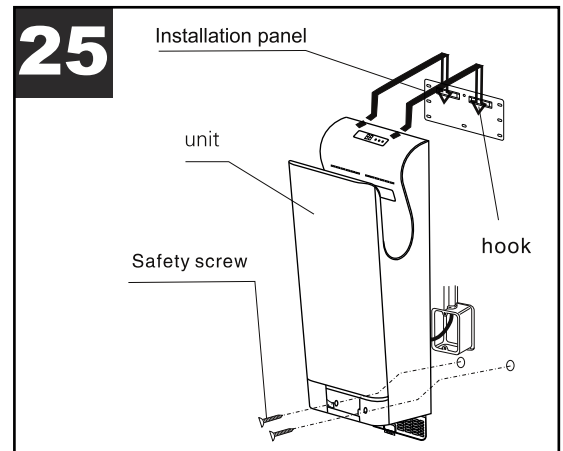

(Fig.26)

## Install the air filter

Insert the air filter inside the appliance as indicated in Fig. 26, then close the door, locking the knob.

## Install the recovery tank

Insert the tank as shown in Fig. 26

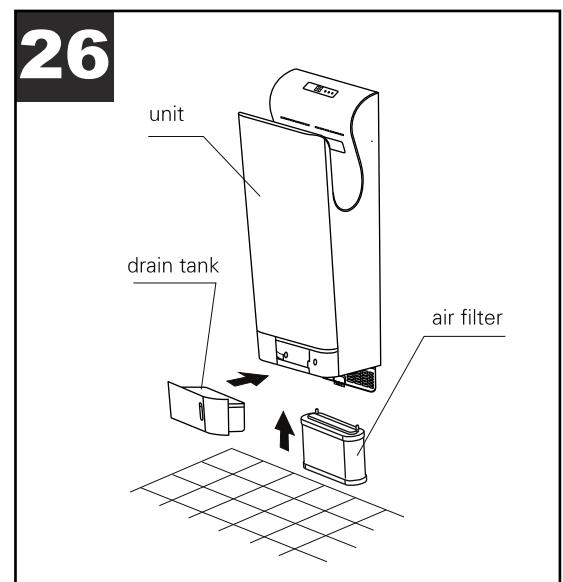

## Test run

	Step	Check	Result
1	Check the voltage of power supply	Please use the rated voltage?	
2	Turn the ground-fault circuit breaker on		
3	Turn the power switch on	Does the power indicator light up?	
4	Dry hands	Is the air blowing?	
5	Check the unit	Is the unit installed firmly? Any vibration or strange noise?	

\* Do not turn the unit power switch on with your hands inside

## Packing list

Unit:	1
Mounting plate	1
5mm Expansion pipe	6
5x25 Self-tapping screw	6
User manual (include packing list and warranty card	1
Method of use figure	1
Drilling adhesives	1

## Disposal

This product conforms to EU Directive EU 2012/19/EC.

This appliance bears the symbol of the barred waste bin. This indicates that, at the end of its useful life, it must not be disposed of as domestic waste, but must be taken to a collection centre for waste electrical and electronic equipment, or returned to a retailer on purchase of a replacement.

It is the user's responsibility to dispose of this appliance through the appropriate channels at the end of its useful life. Failure to do so may incur the penalties established by laws governing waste disposal.

Proper differential collection, and the subsequent recycling, processing and environmentally compatible disposal of waste equipment avoids unnecessary damage to the environment and possible related health risks, and also promotes recycling of the materials used in the appliance.



For further information on waste collection and disposal, contact your local waste disposal service, or the shop from which you purchased the appliance.

Manufacturers and importers fulfil their responsibilities for recycling, processing and environmentally compatible disposal either directly or by participating in collective systems.



VORTICE S.p.A. si riserva il diritto di apportare tutte le varianti migliorative ai prodotti in corso di vendita.  
VORTICE S.p.A. reserves the right to make improvements to products at any time and without prior notice.  
VORTICE S.p.A. se réserve le droit d'apporter toutes les variations afin d'améliorer ses produits en cours de commercialisation.  
VORTICE S.p.A. behält sich vor, alle eventuellen Verbesserungsänderungen an den Produkten des Verkaufsangebots vorzunehmen.  
VORTICE S.p.A. se reserva el derecho a hacer cambios en los productos para su mejora en cualquier momento sin previo aviso.  
VORTICE S.p.A. 公司 股份有限公司 保留在产品销售期间进行产品改良的权利。

---

## VORTICE GROUP COMPANIES

VORTICE S.p.A.  
Strada Cerca, 2 - frazione di Zoate  
20067 - Tribiano (MI)  
Tel. +39 02-90.69.91  
ITALY  
vortice.com  
postvendita@vortice-italy.com

VORTICE INDUSTRIAL Srl  
Via B. Brugnoli, 3  
37063 - Isola della Scala (VR)  
Tel. +39 045 6631042  
ITALY  
vorticeindustrial.com  
info@vorticeindustrial.com

VORTICE VENTILATION SYSTEM (CHANGZHOU) CO.LTD  
Building 19, No.388 West Huanghe Road, Xinbei District,  
Changzhou, Jiangsu Province CAP:213000  
CHINA  
vortice-china.com  
vortice@vortice-china.com

VORTICE LIMITED  
Beeches House-Eastern Avenue  
Burton on Trent - DE 13 0BB  
Tel. +44 1283-49.29.49  
UNITED KINGDOM  
vortice.ltd.uk  
sales@vortice.ltd.uk

VORTICE LATAM S.A.  
Bodega #6  
Zona Franca BES Alajuela - Alajuela 20101  
Tel. (+506) 2201 6934  
COSTA RICA  
vortice-latam.com  
info@vortice-latam.com

CASALS VENTILACIÓN INDUSTRIAL IND., S.L.  
Ctra. Camprodon, s/n  
17860 - Sant Joan de les Abadesses (Girona)  
SPAIN  
casals.com  
ventilacion@casals.com